

SKIRTING BOARDS

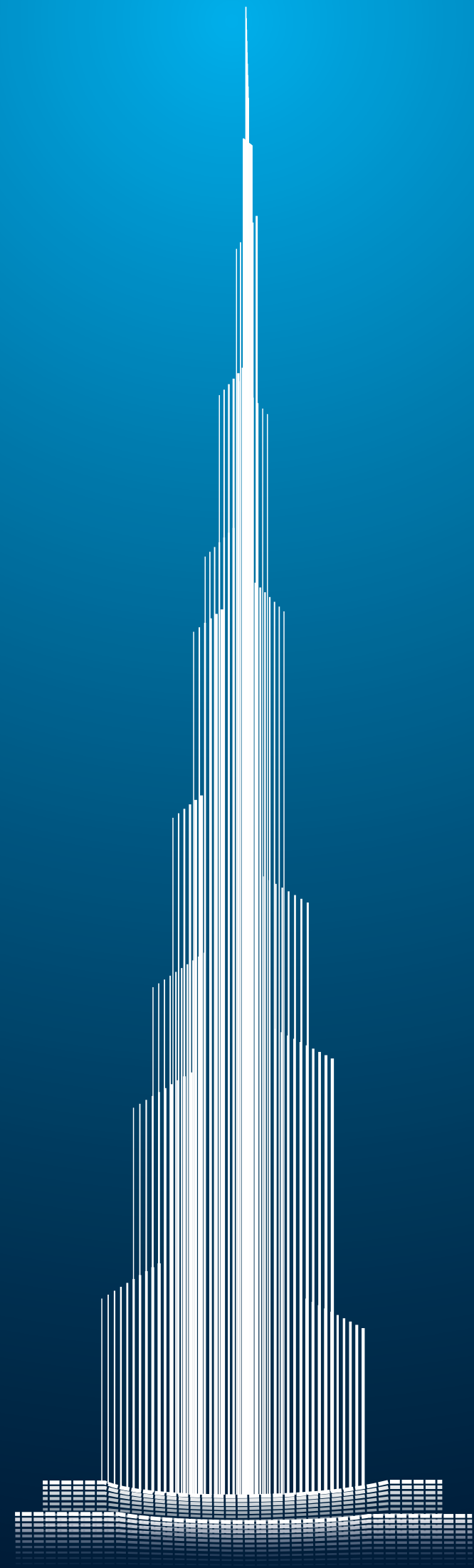



© 2019 All rights reserved by Progress Profiles. Printed in Italy

© 2019 All rights reserved by Progress Profiles. Printed in Italy

**PROSKIRTING CHANNEL** is the new innovative skirting designed with an integrated system for plasterboard walls, and devised to create a skirting flush to the wall with decorative inner grooves for a modern and contemporary touch.

## PROSKIRTING CHANNEL

ANODIZED, BRUSHED, VARNISHED ALUMINIUM



**SUPPORT/ PERFORATED BASE - ANODIZED SILVER ALUM.**  
thermo packed - bar length 2 lm - pack. 20 Pcs - 40 lm

| Article    | H mm | €/lm | €/Pc  |
|------------|------|------|-------|
| PKGCFAA 75 | 75   | 8,76 | 17,52 |

ORDER THE SUPPORT AND THE TOP YOU WISH

**VISIBLE TOP - ANODIZED, BRUSHED, WHITE VARNISHED ALUM.**  
thermo packed bar length 2 lm - pack. 20 Pcs - 40 lm

| Article     | H mm | €/lm  | €/Pc  |
|-------------|------|-------|-------|
| PKCHAA 55   | 55   | 8,50  | 17,00 |
| PKCHBS 55   | 55   | 10,04 | 20,08 |
| PKCHA 55-01 | 55   | 10,04 | 20,08 |

On demand may be realised in other finishes of the colour chart.  
Contact our customer service for minimum quantity, timing and price.

**INTERNAL CORNER - ANODIZED, BRUSHED, WHITE VARNISHED ALUM.** - pack. 5 Pcs

| Article       | H mm | €/Pc | €/Pack. |
|---------------|------|------|---------|
| REPKCH... 55  | 55   | 8,40 | 42,00   |
| REPKCHA 55-01 | 55   | 8,40 | 42,00   |

Available in the colours: AA - BS - 01. The code of the selected colour must be added to the article code.  
E.g.: REPKCH... 55 (chosen finish anodized silver)  
REPKCHAA 55.

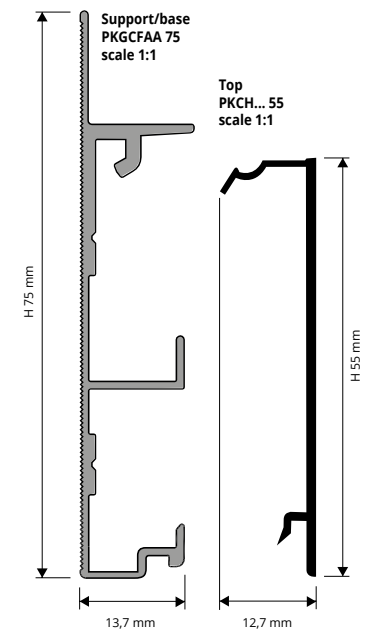

EXAMPLES OF LAYING for instructions see the product below

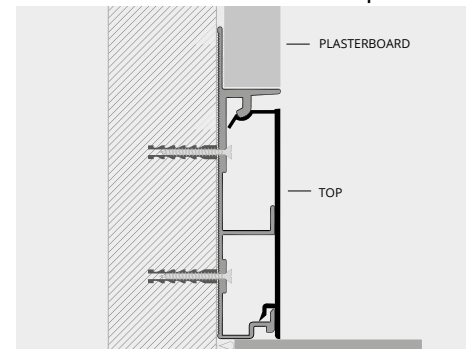

**PROSKIRTING FLAT** is the new innovative skirting designed with an integrated system for plasterboard walls, and devised to create a skirting flush to the wall for a modern and contemporary touch.

## PROSKIRTING FLAT

ANODIZED, BRUSHED, VARNISHED ALUMINIUM



**SUPPORT/ PERFORATED BASE - ANODIZED SILVER ALUM.**  
thermo packed - bar length 2 lm - pack. 20 Pcs - 40 lm

| Article    | H mm | €/lm | €/Pc  |
|------------|------|------|-------|
| PKGCFAA 75 | 75   | 8,76 | 17,52 |

ORDER THE SUPPORT AND THE TOP YOU WISH

**VISIBLE TOP - ANODIZED, BRUSHED, WHITE VARNISHED ALUM.**  
thermo packed - bar length 2 lm - pack. 20 Pcs - 40 lm

| Article     | H mm | €/lm  | €/Pc  |
|-------------|------|-------|-------|
| PKFLAA 60   | 60   | 8,50  | 17,00 |
| PKFLBS 60   | 60   | 10,04 | 20,08 |
| PKFLA 60-01 | 60   | 10,04 | 20,08 |

On demand may be realised in other finishes of the colour chart.  
Contact our customer service for minimum quantity, timing and price.

**EXTERNAL CORNER - ANODIZED, BRUSHED, WHITE VARNISHED ALUM.** - pack. 5 Pcs

| Article       | H mm | €/Pc | €/Pack. |
|---------------|------|------|---------|
| REPKFL... 60  | 60   | 8,40 | 42,00   |
| REPKFLA 60-01 | 60   | 8,40 | 42,00   |

Available in the colours: AA - BS - 01. The code of the selected colour must be added to the article code.  
E.g.: REPKFL... 60 (chosen finish anodized silver)  
REPKFLAA 60.

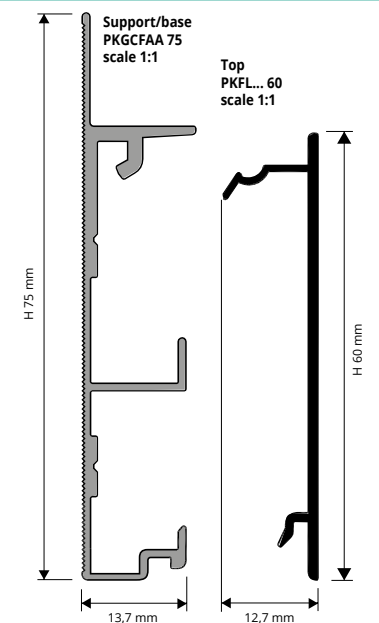

EXAMPLES AND INSTRUCTIONS FOR LAYING METHODS

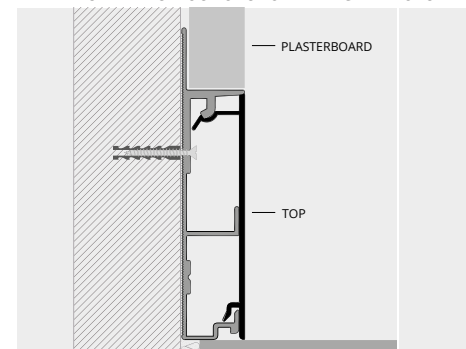

1. Fix the substrate/perforated base to the wall before laying the plasterboard, calculating all the heights and distances. 2. Lay the plasterboard aligning the lower part flush to the "PROSKIRTING CHANNEL" and/or FLAT. 3. Plaster and carry out the surface finishing on the plasterboard. 4. Choose the required Top "PROSKIRTING CHANNEL" and/or FLAT finish, cut and lay the profile fitting the lower part and then the upper part by pressing gently.

**IMPORTANT:** Pay attention to the external edges of the aluminium Proskirting. They must be protected against agents such as adhesives and sealants and against grinding or scraping actions.

\* = Production on demand with minimum quantity of 100 pcs. Delivery time 4/5 weeks, price to agree

Prices are referred to whole packs, 10% increase for minimum orders of 10 pcs, 20% increase for orders of less than 10 pcs.

### COLOURS

|                                |                               |                                   |
|--------------------------------|-------------------------------|-----------------------------------|
| AA - Anodized silver aluminium | BS - Brushed silver aluminium | 01 - White varnished alum. (9016) |
|--------------------------------|-------------------------------|-----------------------------------|

# PROSKIRTING INS

ANODIZED SILVER ALUMINIUM

PROSKIRTING INS is the new innovative skirting designed with an integrated system for plasterboard walls, and devised to create a recessed skirting for a modern and minimalist design in line with the latest trends.

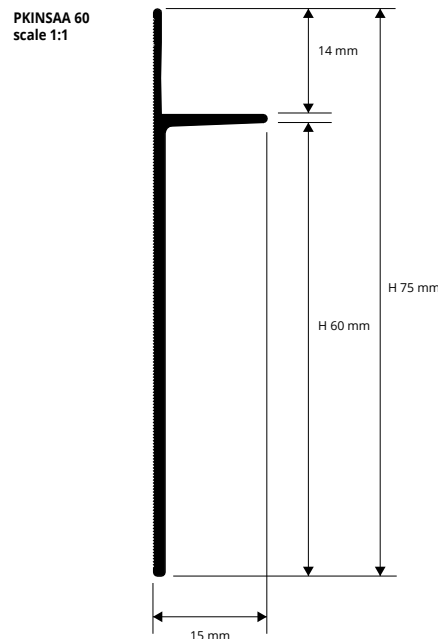

ANODIZED SILVER ALUMINIUM thermo packed  
bar length 2 lm - pack. 30 Pcs - 60 lm

| Article    | H x L mm | €/lm | €/Pc  |
|------------|----------|------|-------|
| PKINSAA 60 | 60 X 15  | 9,37 | 18,74 |

ON DEMAND MAY BE REALISED IN OTHER FINISHES OF THE COLOUR CHART. CONTACT OUR CUSTOMER SERVICE FOR MINIMUM QUANTITY (MINIMUM QUANTITY ORDER OF 500 LM), TIMING AND PRICE.

### COLOURS



### EXAMPLES AND INSTRUCTIONS FOR LAYING METHODS

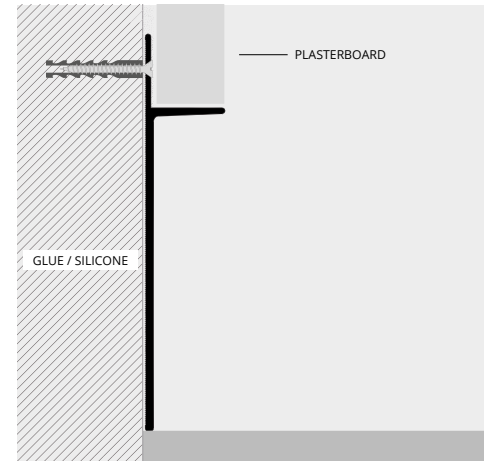

1. Fix "PROSKIRTING INS" using screws (concealed part) and glue/silicone (exposed side), before laying the plasterboard, calculating all the heights and distance. 2. Lay the plasterboard aligning the lower part flush to the "PROSKIRTING INS". 3. Plaster and carry out the surface finishing on the plasterboard. **IMPORTANT:** Pay attention to the external edges of the aluminium "Proskirting". They must be protected against agents such as adhesives and sealants and against grinding or scraping actions.

# PROSKIRTING LINE

ANODIZED SILVER ALUMINIUM

PROSKIRTING LINE in the innovative skirting suitable for smoothed lime, marmorino, stucco, and Venetian coats on civil plaster or plasterboard.

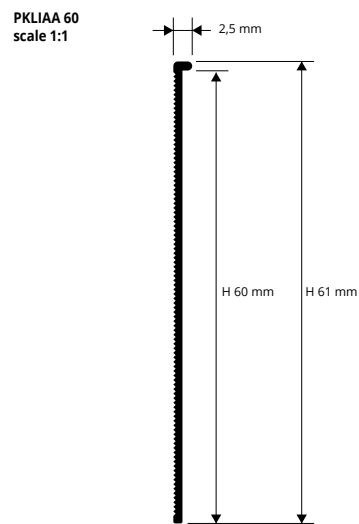

ANODIZED SILVER ALUMINIUM thermo packed  
bar length 2 lm - pack. 40 Pcs - 80 lm

| Article   | H x L mm | €/lm | €/Pc  |
|-----------|----------|------|-------|
| PKLIAA 60 | 60 x 2,5 | 8,14 | 16,28 |

ON DEMAND MAY BE REALISED IN OTHER FINISHES OF THE COLOUR CHART. CONTACT OUR CUSTOMER SERVICE FOR MINIMUM QUANTITY (MINIMUM QUANTITY ORDER OF 500 LM), TIMING AND PRICE.

### COLOURS



### EXAMPLES AND INSTRUCTIONS FOR LAYING METHODS

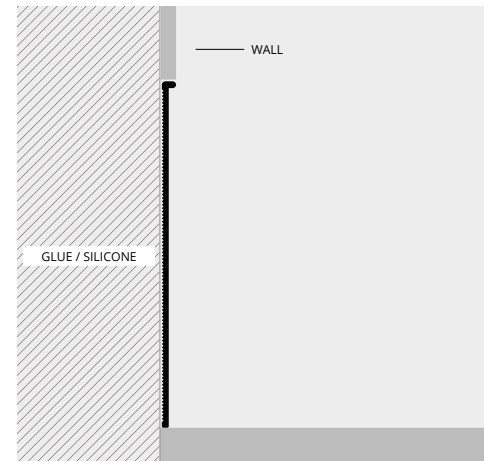

1. Fix the "PROSKIRTING LINE" using glue/silicone (exposed side), before making the required coat, calculating all the heights and distances. 2. Carry out the surface finishing aligning the lower part flush to the "PROSKIRTING LINE". **IMPORTANT:** Pay attention to the external edges of the aluminium "Proskirting". They must be protected against agents such as adhesives and sealants and against grinding or scraping actions.

PROSKIRTING ISP is a joint, inspectional "cable duct" baseboard in aluminium, conceived and designed to hide and protect the passage of electric cables, the ones for computer, telephones and other plants as well, allowing an easy and quick access. The supports that are to be fixed on the wall consent accommodate different utility wires/cables as well. Aesthetically pleasant, it is recommended for various public and private environments: offices, schools, residences, commercial centers etc. Available in silver anodized aluminium (H: 100 mm) and in polished titanium and brushed titanium aluminium (H: 70 mm). In order to facilitate and to perfect the laying process, internal and external angles, plugs and junctions are recommended.

# PROSKIRTING ISP

SILVER ANODIZED ALUMINIUM, TITANIUM POLISHED AND BRUSHED ALUM. (H:70 mm)



SKIRTING ANODIZED SILVER ALUMINIUM  
thermo packed - bar length 2 lm - pack. 25 Pcs - 50 lm  
(H: 100 mm - 40 lm)

| Article     | H mm | €/lm  | €/Pc  |
|-------------|------|-------|-------|
| PKISPAA 70  | 70   | 8,40  | 16,80 |
| PKISPAA 100 | 100  | 12,16 | 24,32 |

On demand may be realised in other finishes of the colour chart. Contact our customer service for minimum quantity, timing and price.

SKIRTING POLISHED TITANIUM ALUMINIUM  
thermo packed - bar length 2 lm - pack. 25 Pcs - 50 lm

| Article    | H mm | €/lm  | €/Pc  |
|------------|------|-------|-------|
| PKISPBT 70 | 70   | 11,79 | 23,58 |

SKIRTING POLISHED BRUSHED TITANIUM ALUMINIUM  
thermo packed - bar length 2 lm - pack. 25 Pcs - 50 lm

| Article    | H mm | €/lm  | €/Pc  |
|------------|------|-------|-------|
| PKISPTS 70 | 70   | 15,66 | 31,32 |

UPON REQUEST AVAILABLE IN H 100mm (MINIMUM QUANTITY 200 lm)  
Skirtings in polished brushed titanium aluminium match with capsules and joints in varnished PVC with polished titanium aluminium effect (see below).

### COLOURS



PUNCHED SUPPORT  
support length 2 cm - pack. 10 Pcs

| Article | H mm | €/Pc | €/Pack. |
|---------|------|------|---------|
| PKGS 55 | 55   | 0,28 | 2,80    |

### ARTICLES NOT FOR SALE SINGLY

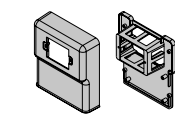

POWER SUPPLY BOX  
SOCKET with FASTENING BASIS

| Article  | €/Pc  |
|----------|-------|
| SPA 1820 | 16,92 |

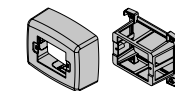

SWITCH BOX  
with BOX BASIS

| Article | €/Pc  |
|---------|-------|
| SI 1410 | 14,28 |

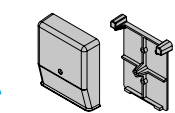

JUNCTION BOX  
with FASTENING BASIS

| Article | €/Pc  |
|---------|-------|
| SD 1210 | 12,69 |



VERTICAL CABLE DUCT PROFILE  
bar length 2,7 lm

| Article | €/lm |
|---------|------|
| PSPV    | 9,52 |

It matches with CSPPK 80. Pag. 197.

### LAYING INSTRUCTIONS

1. Choose "PROSKIRTING ISP" in the desired finish and height. 2. Fix the punched support to the wall with screws every 50 cm. 3. If expected, laying the low-voltage electric cables like web, computer, telephone and satellite TV. 4. Attach the profile to the support applying low pressure.

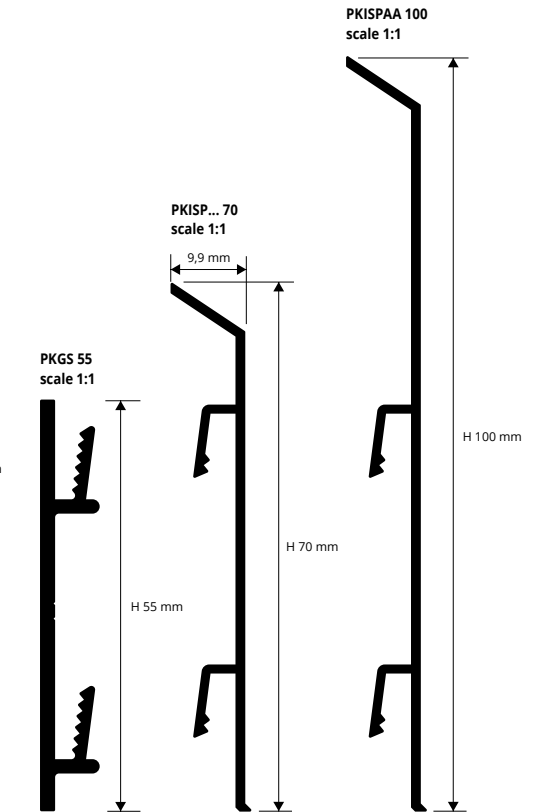

### EXAMPLES OF LAYING

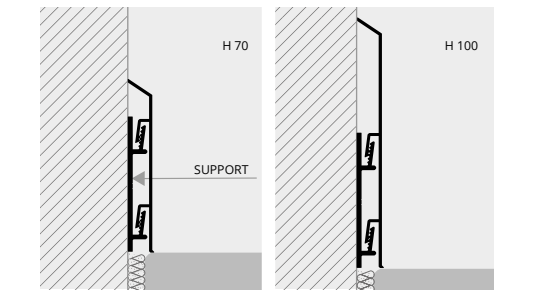

# CORNERS, END CAPS and JOINTS

VARNISHED PLASTIC (FINISHES ANODIZED SILVER, POLISHED TITANIUM)

IN/EXTERNAL CORNER - VARNISHED PLASTIC anod. silver - pack. 5 Pcs

| Article               | H x L mm | €/Pc | €/Pack. |
|-----------------------|----------|------|---------|
| PKIAGI 70 (internal)  | 70 x 24  | 3,22 | 16,10   |
| PKIAGE 70 (external)  | 70 x 5   | 3,22 | 16,10   |
| PKIAGI 100 (internal) | 100 x 24 | 3,22 | 16,10   |
| PKIAGE 100 (external) | 100 x 5  | 3,22 | 16,10   |

JOINTS - VARNISHED PLASTIC anod. silver - pack. 10 Pcs

| Article    | H mm | €/Pc | €/Pack. |
|------------|------|------|---------|
| PKIGIN 70  | 70   | 3,22 | 32,20   |
| PKIGIN 100 | 100  | 3,22 | 32,20   |

END CAPS R / L - VARNISHED PLASTIC ANOD. silver - pack. 10 Pcs (5 right and 5 left)

| Article        | H mm | €/Pc | €/Pack. |
|----------------|------|------|---------|
| PKITDSAA 70/5  | 70   | 3,22 | 32,20   |
| PKITDSAA 100/5 | 100  | 3,22 | 32,20   |



IN/EXTERNAL CORNER - VARNISHED PLASTIC polished titanium - pack. 5 Pcs

| Article                | H x L mm | €/Pc | €/Pack. |
|------------------------|----------|------|---------|
| PKIAGIBT 70 (internal) | 70 X 24  | 5,08 | 25,40   |
| PKIAGEBT 70 (external) | 70 X 5   | 5,08 | 25,40   |

JOINTS - VARNISHED PLASTIC polished titanium - pack. 10 Pcs

| Article     | H mm | €/Pc | €/Pack. |
|-------------|------|------|---------|
| PKIGINBT 70 | 70   | 5,08 | 50,80   |

END CAPS R / L - VARNISHED PLASTIC poli. titanium - pack. 10 Pcs (5 right and 5 left)

| Article       | H mm | €/Pc | €/Pack. |
|---------------|------|------|---------|
| PKITDSBT 70/5 | 70   | 5,08 | 50,80   |

Available on demand aluminium prewelded internal and external flush corners. Price and delivery time to be agreed.





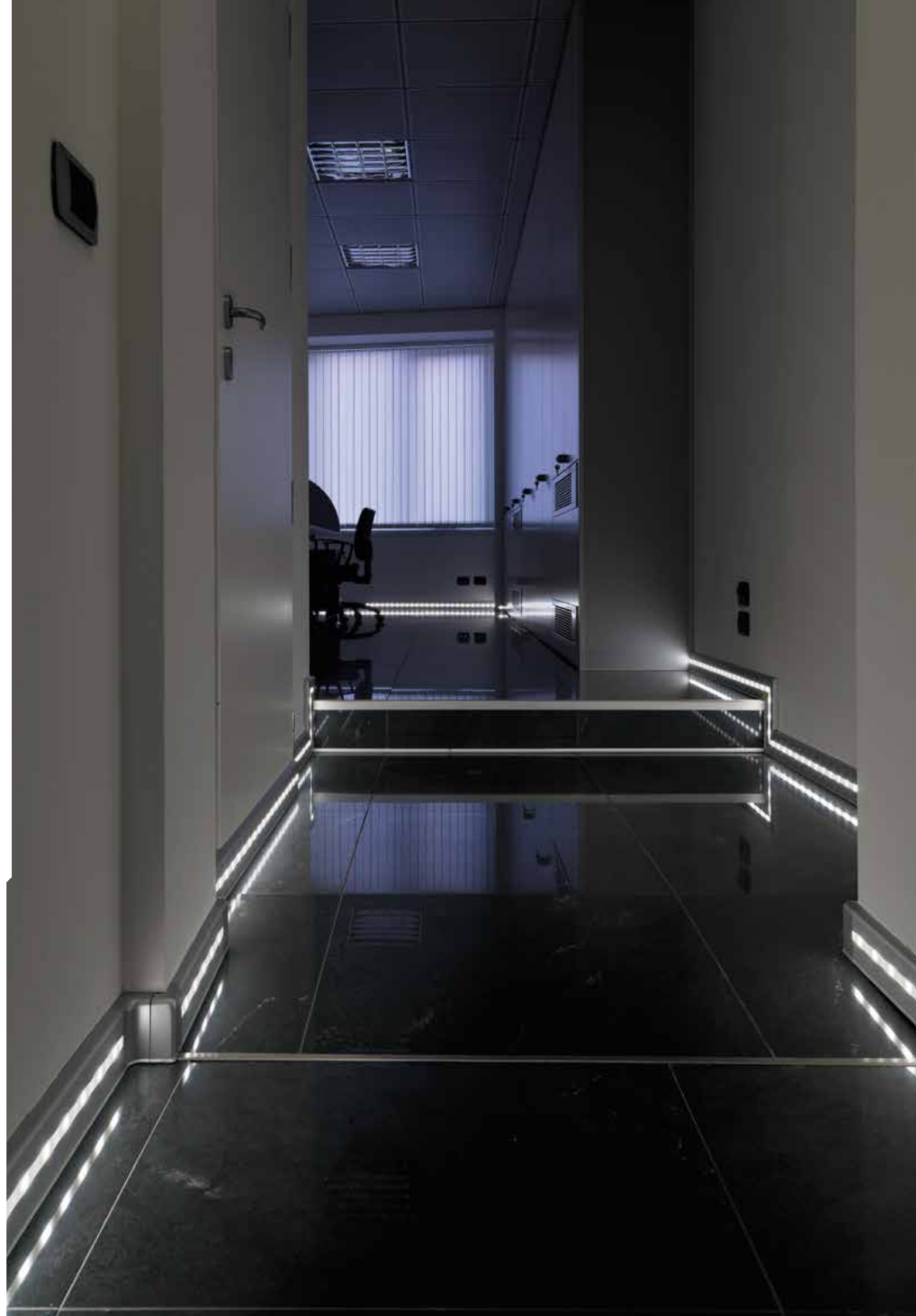

© 2010 All rights reserved by Progress Profiles. Printed in Italy

© 2010 All rights reserved by Progress Profiles. Printed in Italy

**PROSKIRTING LED** is an innovative patented baseboard called "cable duct" in anodized aluminium, with illumination led system incorporated. Conceived and designed to illuminate the passage zone such as corridors and house and office entrances as well. It generates soft and indirect light. Moreover, it solves many other problems such as the laying of the baseboard itself, the passage of the electric cables, the ones for PC, telephone and other plants as well. **PROSKIRTING LED** has been designed with double function and utility: 1- **PROSKIRTING LED** complete PKLEDAA 80 is an inspectional joint baseboard composed of PKGS 66 support for fixing it with screws on the wall and the **PROSKIRTING LED** PKLEDAA 80 at sight profile. 2- **PROSKIRTING LED** PKLEDAA 80 is a at sight baseboard profile to be fixed directly with silicone/ adhesive. It is not an inspectional one like **PROSKIRTING LED** complete, and is available also in auto adhesive version (PKLEDAA 80A).

# PROSKIRTING LED

ANODIZED SILVER ALUMINIUM WITH LED AND POWER SUPPLY BOX



**SKIRTING BOARD IN ANOD. SILVER ALU. WITHOUT ADHESIVE. ADAPTOR LED, LED & FLAT NOT INCLUDED (indicate the article) thermo packed - bar length 2 lm - pack. 10 Pcs - 20 lm**

| Article    | H mm | €/lm  | €/Pc  |
|------------|------|-------|-------|
| PKLEDAA 80 | 80   | 21,63 | 43,26 |

**SKIRTING BOARD IN ANOD. SILVER ALUM. WITH ADHESIVE, ADAPTOR LED, LED & FLAT NOT INCLUDED (indicate the article) thermo packed - bar length 2 lm - pack. 10 Pcs - 20 lm**

| Article     | H mm | €/lm  | €/Pc    |
|-------------|------|-------|---------|
| PKLEDAA 80A | 80   | 24,21 | 48,42 * |

Please, specify in your order the code of the FLAT you choose : matt or gloss. Eg.: PKLEDAA 80 + PKGPIAL

**POLYCARBONATE FLAT - bar length 2 lm**

| Article |       | €/lm |
|---------|-------|------|
| PKGPIAL | Gloss | 4,12 |
| PKGPIAO | Matt  | 4,12 |

**ADHESIVE FLEXIBLE LED COIL length 5 lm - pack.1 ROLL**

| Article                  | €/lm  | €/Pack. |
|--------------------------|-------|---------|
| LEDN (neutral light 12V) | 17,72 | 88,60   |
| LEDF (cold light 12V)    | 17,72 | 88,60   |
| LEDC (hot light 12V)     | 17,72 | 88,60   |

**POWER SUPPLY BOX SOCKET with FASTENING BASIS**

| Article  | €/Pc  |
|----------|-------|
| SPA 1820 | 16,92 |

**LED POWER SUPPLY 75W - 12V**

| Article  | €/Pc  |
|----------|-------|
| ALL 7512 | 64,89 |



**CABLE RACEWAY/ SUPPORT- COEXTRUDED PVC bar length 2 lm - pack. 20 Pcs - 40 lm**

| Article  | H mm | €/lm | €/Pc |
|----------|------|------|------|
| CSPPK 80 | 70   | 4,49 | 8,98 |

**PUNCHED SUPPORT - NATURAL ALUMINIUM support length 2 cm - pack. 10 Pcs**

| Article | H mm | €/Pc | €/Pack. |
|---------|------|------|---------|
| PKGS 66 | 66   | 0,28 | 2,80    |

ARTICLES NOT FOR SALE SINGLY

COLOURS



ON DEMAND MAY BE REALISED IN OTHER FINISHES OF THE COLOUR CHART. CONTACT OUR CUSTOMER SERVICE FOR MINIMUM QUANTITY, TIMING AND PRICE.

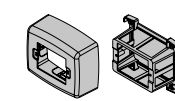

**SWITCH BOX with BOX BASIS**

| Article | €/Pc  |
|---------|-------|
| SI 1410 | 14,28 |

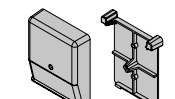

**JUNCTION BOX with FASTENING BASIS**

| Article | €/Pc  |
|---------|-------|
| SD 1210 | 12,69 |

**VERTICAL CABLE DUCT PROFILE bar length 2,7 lm**

| Article | €/lm |
|---------|------|
| PSPV    | 9,52 |

It matches with CSPPK 80.

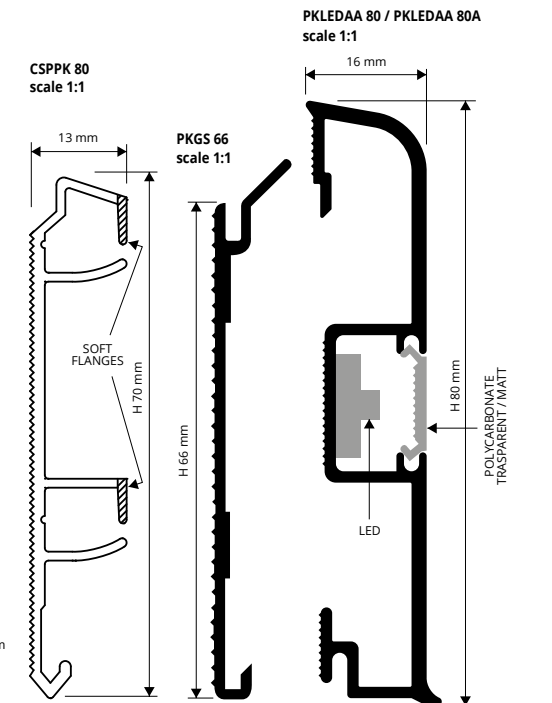

EXAMPLES AND INSTRUCTIONS FOR LAYING METHODS

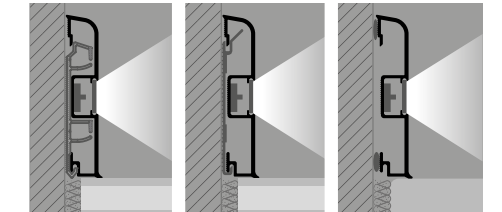

1. Fix the support on the wall putting the screws and glue every 50 cm (recommended). Make a test with "PROSKIRTING LED" in order to value the height and the correct position of supports. 2. Fix in the chosen spaces the socket/ power supply box basis, switch box basis and, eventually, the junction box. 3. Connect 220V supply to power/ transformer unit, and afterwards, connect the "PROSKIRTING LED" bar next to power unit. 4. Connect the pre-applied led bars inside the "PROSKIRTING LED" with the supplied cables/ wires in continuous way. 5. The power supply unit guarantees about 15 lm of led illumination, beyond that distance it is necessary to add another power supply box/socket. When fixing without support, clean the surface carefully so that it's dry and with no grass trace, apply the silicone on the knurled sides of the profile and lay down correctly, pressing uniformly and with no hammering. For the application of "PROSKIRTING LED" with adhesive, we recommend the temperature not below 15°.

## CORNERS, END CAPS and JOINTS

VARNISHED PLASTIC SILVER FINISH

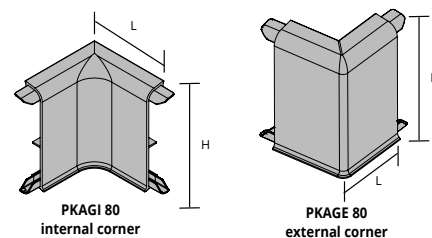

PKAGI 80 internal corner

PKAGE 80 external corner

PKGIN 80 joint

PKTDSAA 80/5 end caps

**IN/EXTERNAL CORNER - VARNISHED PLASTIC (SILVER FIN.) pack. 5 Pcs**

| Article             | H x L mm | €/Pc | €/Pack. |
|---------------------|----------|------|---------|
| PKAGI 80 (internal) | 80 X 40  | 3,89 | 19,45   |
| PKAGE 80 (external) | 80 X 40  | 3,89 | 19,45   |

**JOINTS - VARNISHED PLASTIC (SILVER FIN.) - pack. 10 Pcs**

| Article  | H mm | €/Pc | €/Pack. |
|----------|------|------|---------|
| PKGIN 80 | 80   | 3,16 | 31,60   |

**END CAPS R / L - VARNISHED PLASTIC (SILVER FIN.) pack. 10 Pcs (5 right and 5 left)**

| Article      | H mm | €/Pc | €/Pack. |
|--------------|------|------|---------|
| PKTDSAA 80/5 | 80   | 3,16 | 31,60   |



\* = Production on demand with minimum quantity of 100 pcs. Delivery time 4/5 weeks, price to agree

Prices are referred to whole packs, 10% increase for minimum orders of 10 pcs, 20% increase for orders of less than 10 pcs.



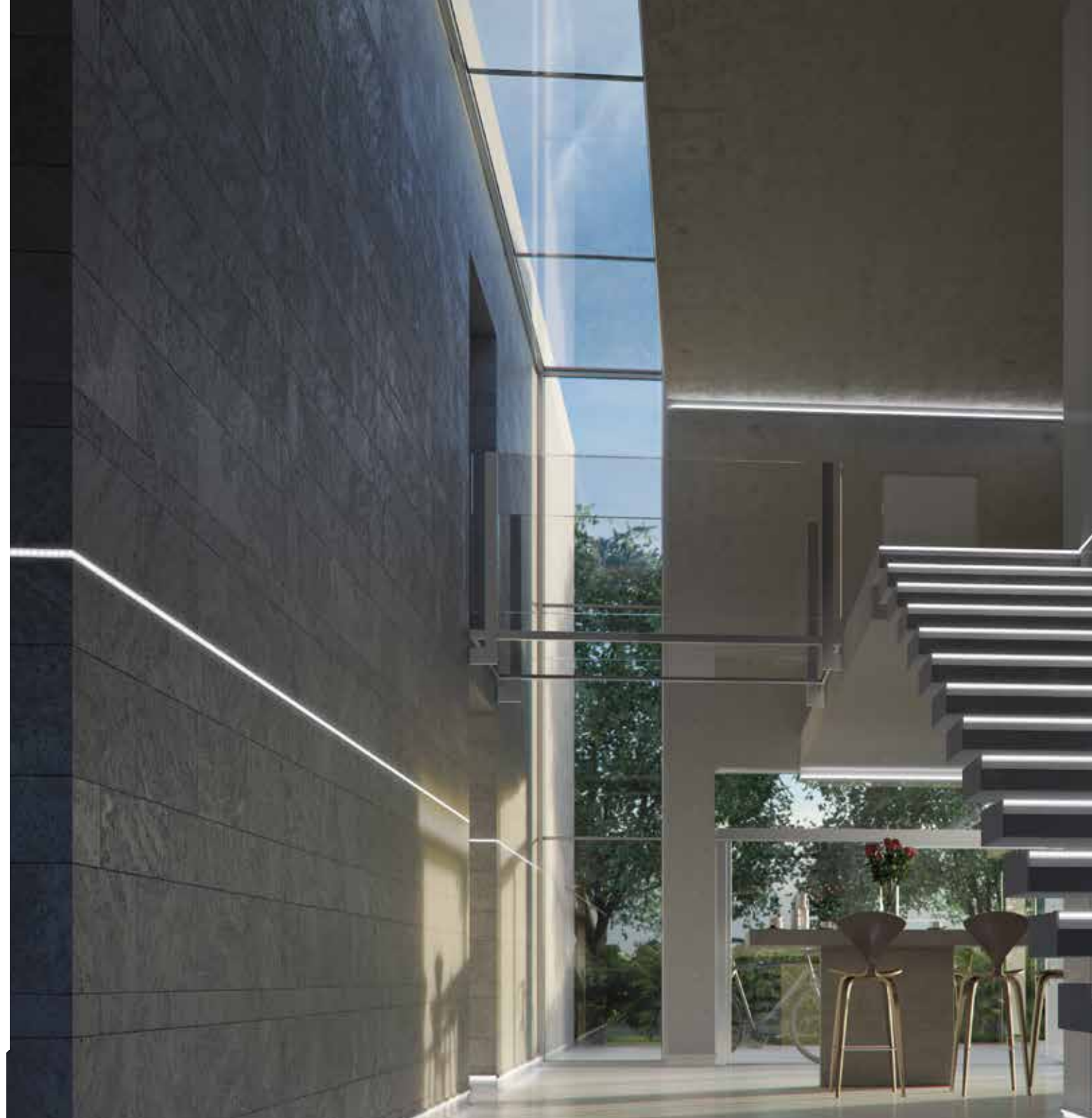

© 2019 All rights reserved by Progress Profiles, Printed in Italy

© 2019 All rights reserved by Progress Profiles, Printed in Italy

# PROSKIRTING GILED

ANODIZED ALUMINIUM  
POLISHED ALUMINIUM

**PROSKIRTING GILED** is an innovative profile in silver anodized aluminum and polished chrome, with 80 and 100 mm height, with a rigid vinyl resin TOP PROFILE, with a 17,5mm exposed surface, available in 9 different marmorised finishes, provided with an integrated LED lighting system generating a soft and indirect light. **PROSKIRTING GILED** can be used instead of the classic skirting board or rotated 180 degrees and installed along the ceiling edges, allowing to cover up to 15mm wide joints. The reflection of the LED light by the aluminum surface of the profile creates a modern atmosphere. **PROSKIRTING GILED** is equipped with all the trim pieces available such as inside and outside corner, joints, end caps and power supply box. *Conceived and designed by the designer Gilberto Toneguzzi.*



**SKIRTING H 80 mm IN ANOD. SILVER, POLI. CHROME ALUM.**  
TOP PROFILE NOT INCLUDED (indicate the article)  
thermo packed - bar length 2 lm - pack. 20 Pcs - 40 lm

| Article               | H mm | €/lm  | €/Pc    |
|-----------------------|------|-------|---------|
| PKGLEDA 80            | 80   | 13,13 | 26,26   |
| PKGLEDBC 80           | 80   | 14,94 | 29,88 * |
| PKGLEDA 80A (adh.)    | 80   | 16,22 | 32,44   |
| PKGLEDBC 80A (adh.)   | 80   | 18,03 | 36,06 * |
| PKGLEDA 80F (punch.)  | 80   | 14,68 | 29,36 * |
| PKGLEDBC 80F (punch.) | 80   | 16,48 | 32,96 * |

**TOP PROFILE IN PVC - bar length 2 lm**

| Article    | €/lm |
|------------|------|
| TOPPKGL... | 3,09 |

In the order specify the chosen colour of the TOP PROFILE.  
E.g. TOPPKGL... (colour gold) TOPPKGLMBO.

Specify the chosen colour of the PVC TOP PROFILE (see below).

**PVC TOP PROFILE COLOURS**  
On demand may be realised in other finishes of the colour chart.  
Contact our customer service for minimum quantity, timing and price.



**SKIRTING COLOURS**



**SKIRTING H 100 mm IN ANOD. SILVER, POLI. CHROME ALUM.**  
TOP PROFILE NOT INCLUDED (indicate the article)  
thermo packed - bar length 2 lm - pack. 20 Pcs - 40 lm

| Article                | H mm | €/lm  | €/Pc    |
|------------------------|------|-------|---------|
| PKGLEDA 100            | 100  | 14,42 | 28,84   |
| PKGLEDBC 100           | 100  | 17,25 | 34,50 * |
| PKGLEDA 100A (adh.)    | 100  | 17,51 | 35,02   |
| PKGLEDBC 100A (adh.)   | 100  | 20,34 | 40,68 * |
| PKGLEDA 100F (punch.)  | 100  | 15,97 | 31,94 * |
| PKGLEDBC 100F (punch.) | 100  | 18,80 | 37,60 * |

**ADHESIVE FLEXIBLE LED COIL**

length 5 lm - pack.1 ROLL

| Article              | €/lm  | €/Pack. |
|----------------------|-------|---------|
| LEDN (neutral light) | 17,72 | 88,60   |
| LEDF (cold light)    | 17,72 | 88,60   |
| LEDC (hot light)     | 17,72 | 88,60   |

**LED ADAPTOR AC/DC 75W - 12V (15 lm)**  
**LED ADAPTOR AC/DC 25W - 12V (5 lm)**

| Article                   | €/Pc  |
|---------------------------|-------|
| ALL 7512 (supplies 15 lm) | 64,89 |
| ALL 2512 (supplies 5 lm)  | 44,50 |

**EXAMPLES AND INSTRUCTIONS FOR LAYING METHODS**

1. Choose "PROSKIRTING GILED" depending on the desired finish and fixing system; 2. If you are installing the version with adhesive: clean the surface on which the profile is to be laid, ensuring that it is dry. Remove the protective film and place the profile, applying adequate pressure on it. If you are installing the punched version, drill the surface on which the profile is to be laid using a drill with 5mm diameter and insert the 5x25mm screws. Screw the profile; 3. Connect the 12/24 V adaptor; 4. Fix the LED light to the inclined side of the aluminum profile or to the vinyl resin support and install electrical wiring; 5. Apply the rigid vinyl resin insert to the aluminum profile.

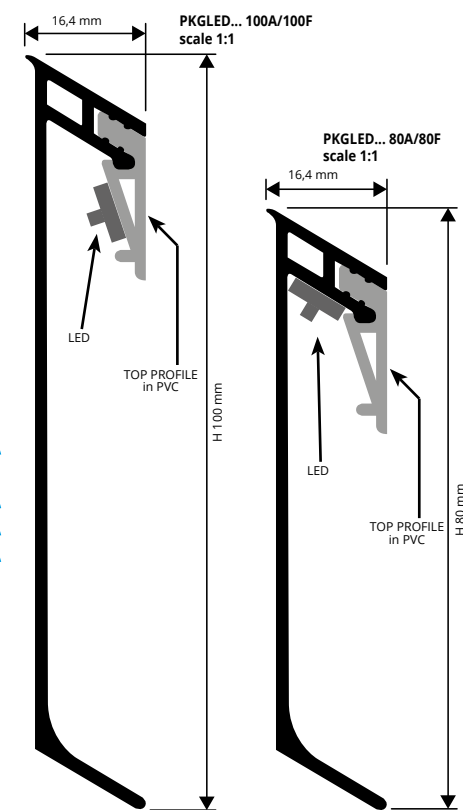

## CORNERS, END CAPS and JOINTS

VARNISHED PLASTIC

**FLUSH CORNERS - varnished plastic**

**IN/EXTERNAL CORNER - FLUSH CORNERS**  
VARNISHED PLASTIC ANOD. SILVER, POLI. CHROME - pack. 5 Pcs

| Article                 | H x L mm | €/Pc | €/Pack. |
|-------------------------|----------|------|---------|
| REPKLEDA 80 (external)  | 80 x 10  | 4,07 | 20,35   |
| RIPKLEDA 80 (internal)  | 80 x 10  | 4,07 | 20,35   |
| REPKLEDBC 80 (external) | 80 x 10  | 5,67 | 28,35 * |
| RIPKLEDBC 80 (internal) | 80 x 10  | 5,67 | 28,35 * |

**FLUSH JOINT - VARNISHED PLASTIC ANOD. SILVER, POLI. CHROME**  
pack. 5 Pcs

| Article      | H mm | €/Pc | €/Pack. |
|--------------|------|------|---------|
| GIPKLEDA 80  | 80   | 3,40 | 17,00   |
| GIPKLEDBC 80 | 80   | 4,89 | 24,45 * |

**FLUSH END CAPS R / L - VARNISHED PLASTIC ANOD. SILVER, POLI. CHROME - pack. 6 Pcs (3 right and 3 left)**

| Article     | H mm | €/Pc | €/Pack. |
|-------------|------|------|---------|
| TPKLEDA 80  | 80   | 3,40 | 20,40   |
| TPKLEDBC 80 | 80   | 4,89 | 29,34 * |

**FLUSH CORNERS - varnished plastic**

**IN/EXTERNAL CORNER - FLUSH CORNERS**  
VARNISHED PLASTIC ANOD. SILVER, POLI. CHROME - pack. 5 Pcs

| Article                  | H x L mm | €/Pc | €/Pack. |
|--------------------------|----------|------|---------|
| REPKLEDA 100 (external)  | 100 x 10 | 4,64 | 23,20   |
| RIPKLEDA 100 (internal)  | 100 x 10 | 4,64 | 23,20   |
| REPKLEDBC 100 (external) | 100 x 10 | 6,18 | 30,90 * |
| RIPKLEDBC 100 (internal) | 100 x 10 | 6,18 | 30,90 * |

**FLUSH JOINT - VARNISHED PLASTIC ANOD. SILVER, POLI. CHROME**  
pack. 5 Pcs

| Article       | H mm | €/Pc | €/Pack. |
|---------------|------|------|---------|
| GIPKLEDA 100  | 100  | 3,91 | 19,55   |
| GIPKLEDBC 100 | 100  | 5,56 | 27,80 * |

**FLUSH END CAPS R / L - VARNISHED PLASTIC ANOD. SILVER, POLI. CHROME - pack. 6 Pcs (3 right and 3 left)**

| Article      | H mm | €/Pc | €/Pack. |
|--------------|------|------|---------|
| TPKLEDA 100  | 100  | 3,91 | 23,46   |
| TPKLEDBC 100 | 100  | 5,56 | 33,36 * |

**INTERNAL CORNER** RIPKLEDA... 80/100



**EXTERNAL CORNER** REPKLEDA... 80/100



**JOINT** GIPKLEDA... 80/100



**END CAPS** TPKLEDA... 80/100



\* = Production on demand with minimum quantity of 100 pcs. Delivery time 4/5 weeks, price to agree

Prices are referred to whole packs, 10% increase for minimum orders of 10 pcs, 20% increase for orders of less than 10 pcs.



# PROSKIRTING

ANODIZED SILVER ALUMINIUM

PROSKIRTING is an innovative patented "cable channel" skirting in anodized aluminium. Studied and designed to resolve various problems related to the installation of skirting and to the laying of electrical, computer and telephone cables and other service systems. PROSKIRTING has been designed to offer a dual function: 1- PROSKIRTING complete PKAA 80 is a snap-on inspectable skirting consisting of a support PKGS 66 to be screwed to the wall and the visible profile PROSKIRTING PKAA 80. 2- PROSKIRTING PKAA 80 is the visible skirting profile to be fixed directly with silicone/adhesive. It is not inspectable like PROSKIRTING complete; it is also available in a self-adhesive version (PKAA 80A).

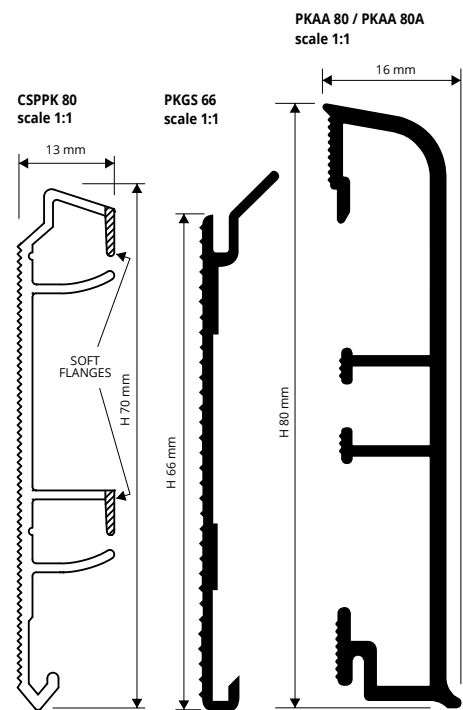

**ONLY SKIRTING (for sale singly) - ANODIZED SILVER ALUMINIUM thermo packed** - bar length 2 lm - pack. 10 Pcs - 20 lm

| Article                  | H mm | €/lm  | €/Pc  |
|--------------------------|------|-------|-------|
| PKAA 80                  | 80   | 12,02 | 24,04 |
| PKAA 80A (with adhesive) | 80   | 15,80 | 31,60 |

On demand may be realised in other finishes of the colour chart. Contact our customer service for minimum quantity, timing and price.

**Advantages:** profile to be glued. Aesthetically superior thanks to the HI-TECH design with rounded shell-shape top and bottom edges that are easy to clean. PROSKIRTING is made in anodized aluminium with silver finish; the anodizing layer is approx. 15/20 micron. Recommended for indoor and outdoor use thanks to its good anti-oxidation properties.

- Single visible skirting profile, which may be inspectable or fixed.
- Minimum stock investment with just 2 products for three functions.
- Easy to install and clean.
- Patented innovative HI-TECH design.
- Inside-outside corners-end caps and joints varnished in the same finish as the profile.
- The PROSKIRTING profile is antistatic and stops electromagnetic and electrostatic discharge.



**CABLE RACEWAY/ SUPPORT- COEXTRUDED PVC** bar length 2 lm - pack. 20 Pcs - 40 lm

| Article  | €/lm | €/Pc |
|----------|------|------|
| CSPPK 80 | 4,49 | 8,98 |

**PUNCHED SUPPORT - NATURAL ALUMINIUM** support length 2 cm - pack. 10 Pcs

| Article | H mm | €/Pc | €/Pack. |
|---------|------|------|---------|
| PKGS 66 | 66   | 0,28 | 2,80    |

ARTICLES NOT FOR SALE SINGLY

COLOURS



**OTHER COLOURS ANODIZED, POLISHED, BRUSHED AND VARNISHED AVAILABLE.**

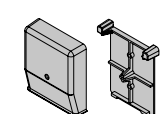

**POWER SUPPLY BOX**  
SOCKET with FASTENING BASIS

| Article  | €/Pc  |
|----------|-------|
| SPA 1820 | 16,92 |



**JUNCTION BOX**  
with FASTENING BASIS

| Article | €/Pc  |
|---------|-------|
| SD 1210 | 12,69 |



**VERTICAL CABLE DUCT PROFILE**  
bar length 2,7 lm

| Article | €/lm |
|---------|------|
| PSPV    | 9,52 |

It matches with CSPPK 80

## CORNERS, END CAPS and JOINTS

VARNISHED PLASTIC SILVER FINISH.

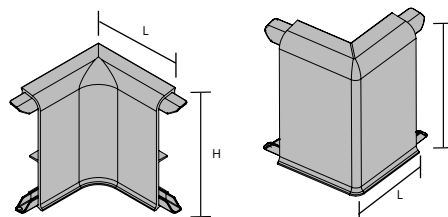

PKAGI 80 internal corner / PKAGE 80 external corner

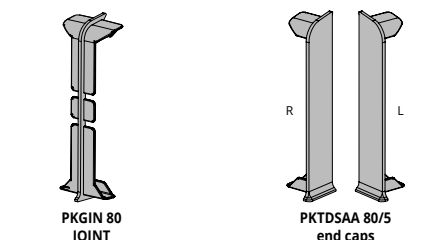

PKGIN 80 JOINT / PKTDSAA 80/5 end caps

**IN/EXTERNAL CORNER - VARNISHED PLASTIC (silver finish.)** pack. 5 Pcs

| Article             | H x L mm | €/Pc | €/Pack. |
|---------------------|----------|------|---------|
| PKAGI 80 (internal) | 80 x 40  | 3,89 | 19,45   |
| PKAGE 80 (external) | 80 x 40  | 3,89 | 19,45   |

**JOINTS - VARNISHED PLASTIC (silver finish.)** - pack. 10 Pcs

| Article  | H mm | €/Pc | €/Pack. |
|----------|------|------|---------|
| PKGIN 80 | 80   | 3,16 | 31,60   |

**END CAPS R / L - VARNISHED PLASTIC (silver finish.)** pack. 10 Pcs (5 right and 5 left)

| Article      | H mm | €/Pc | €/Pack. |
|--------------|------|------|---------|
| PKTDSAA 80/5 | 80   | 3,16 | 31,60   |

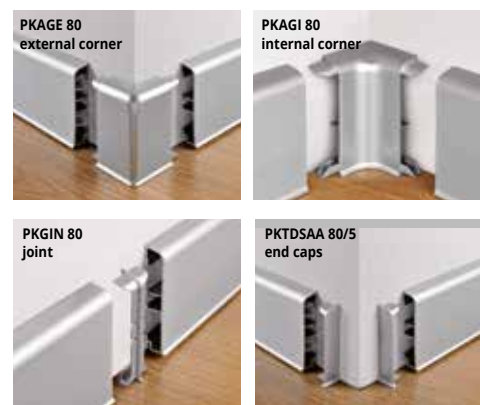

PROSKIRTING 40 is an anodized silver aluminium skirting profile, with a height of 40 mm. It can be fixed directly to the wall with adhesive (non-inspectionable adhesive version PKAA 40A) or to a support (inspectionable version PKAA 40) in punched aluminium, pieces 20 mm long to be fixed to the wall with screws, every about 50 cm.

# PROSKIRTING 40

ANODIZED SILVER ALUMINIUM



**SKIRTING - SILVER ANODIZED ALUMINIUM thermo packed** bar length 2 ml - pack. 20 PZ - 40 ml

| Article                    | H mm | €/lm | €/Pc  |
|----------------------------|------|------|-------|
| PKAA 40 (without adhesive) | 40   | 6,28 | 12,56 |
| PKAA 40A (with adhesive)   | 40   | 8,19 | 16,38 |

**PUNCHED SUPPORT - NATURAL ALUMINIUM** support length 2 cm - pack. 10 Pcs

| Article | H mm | €/Pc | €/Pack. | It matches with PKAA 40 |
|---------|------|------|---------|-------------------------|
| PKGS 37 | 37   | 0,28 | 2,80    |                         |

COLOURS



AA - Anodized silver alum.

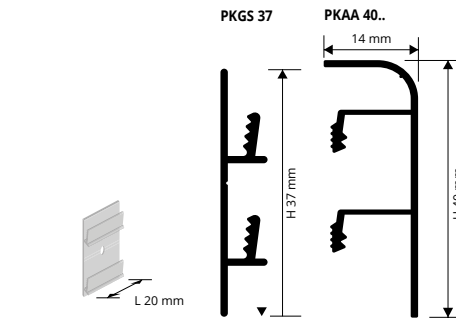

## CORNERS, END CAPS and JOINTS

VARNISHED PLASTIC (SILVER FINISH)

**IN/EXTERNAL CORNERS - VARNISHED PLASTIC (silver finish.)** pack. 5 Pcs

| Article             | H mm | €/Pc | €/Pack. |
|---------------------|------|------|---------|
| PKAGI 40 (internal) | 40   | 3,89 | 19,45   |
| PKAGE 40 (external) | 40   | 3,89 | 19,45   |

**JOINTS - VARNISHED PLASTIC (silver finish.)** - pack. 10 Pcs

| Article  | H mm | €/Pc | €/Pack. |
|----------|------|------|---------|
| PKGIN 40 | 40   | 3,16 | 31,60   |

**END CAPS R / L - VARNISHED PLASTIC (silver finish.)** - pack. 10 Pcs (5 right and 5 left)

| Article      | H mm | €/Pc | €/Pack. |
|--------------|------|------|---------|
| PKTDSAA 40/5 | 40   | 3,16 | 31,60   |

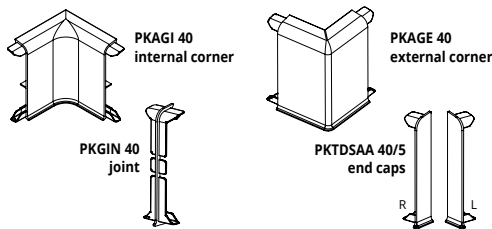

PROSKIRTING SHELL is an innovative aluminium skirting board, with 70mm height, in silver anodized finish. The skirting board can be fixed to the wall with silicone or screwed to 20mm long aluminium punched flanges, that have to be fastened to the wall at 50cm distance from each other. It allows to cover up to 25mm high perimeter edges. Moreover the version with punched flanges allows the housing of low tension electrical cables, such as internet, phone, TV and satellite cables and can be easily inspected. The optional completing pieces, such as inside/outside corners, linking elements and end caps make PROSKIRTING SHELL easy to install and guarantee a practical and elegant end result.

## PROSKIRTING SHELL

ANODIZED SILVER ALUMINIUM



**SKIRTING - ANODIZED SILVER ALUMINIUM thermo packed** bar length 2 lm - pack. 25 Pcs - 50 lm

| Article                      | H mm | €/lm  | €/Pc  |
|------------------------------|------|-------|-------|
| PKSHAA 70 (without adhesive) | 70   | 12,10 | 24,20 |
| PKSHAA 70A (with adhesive)   | 70   | 15,97 | 31,94 |

COLOURS



AA - Anodized silver alum.



**PUNCHED SUPPORT - NATURAL ALUMINIUM** support length 2 cm - pack. 10 Pcs

| Article | H mm | €/Pc | €/Pack. |
|---------|------|------|---------|
| PKGS 55 | 55   | 0,28 | 2,80    |

ARTICLES NOT FOR SALE SINGLY

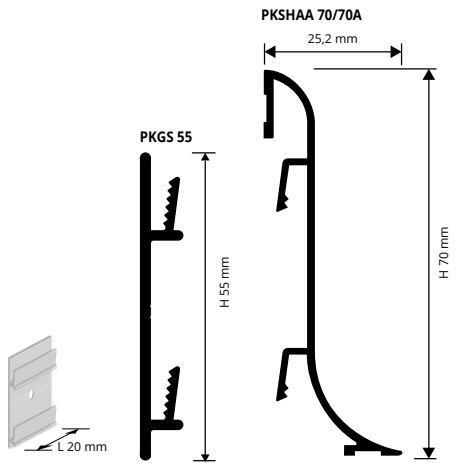

**EXAMPLES AND INSTRUCTIONS FOR LAYING METHODS**

1. Choose the right version of "PROSKIRTING SHELL" depending on the desired fixing solution;
2. If you want to build low tension electrical cables (e.g. internet, phone, TV and satellite cables) into the profile, fasten the punched flanges to the wall using dowels at 50cm distance from each other;
3. Install electrical wiring and fasten "PROSKIRTING SHELL" to the flanges;
4. If you are installing the version with adhesive, first clean the surface where the profile will be installed, then apply the silicone once the surface is dry. Remove the protective film and lay the profile, applying adequate pressure on it.

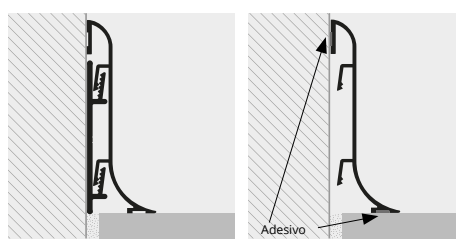

## CORNERS, END CAPS and JOINTS

VARNISHED PLASTIC (SILVER FINISH)

**EDGE COVER CORNERS**

**IN/EXTERNAL CORNER - EDGE COVER VARNISHED PLASTIC (silver finish.)** - pack. 5 Pcs

| Article                | H x L mm | €/Pc | €/Pack. |
|------------------------|----------|------|---------|
| RIPKSHAA 70 (internal) | 70 x 20  | 3,24 | 16,20   |
| REPKSHAA 70 (external) | 70 x 20  | 3,24 | 16,20   |

**JOINT - EDGE COVER - VARNISHED PLASTIC (silver finish.)** pack. 5 Pcs

| Article     | H mm | €/Pc | €/Pack. |
|-------------|------|------|---------|
| GIPKSHAA 70 | 70   | 3,24 | 16,20   |

**END CAPS R / L - EDGE COVER VARNISHED PLASTIC (silver finish.)** - pack. 6 Pcs (3 right and 3 left)

| Article    | H mm | €/Pc | €/Pack. |
|------------|------|------|---------|
| TPKSHAA 70 | 70   | 3,24 | 19,44   |

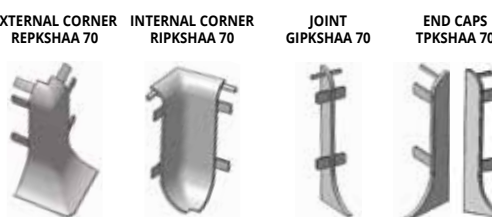





## SKIRTING 40

POLISHED AND SATINED STAINLESS STEEL AISI 304/1.4301-V2A

**SKIRTING 40** made in stainless steel AISI 304/1.4301-V2A in height 40 mm. Available with or without adhesive. Superior aesthetic quality, extremely strong and easy to lay, it is ideal for all public and private environments that require high standards of hygiene and image. Used increasingly more often in contrast combinations with wood, carpeted floors, etc. for an unmistakable hi-tech effect. In order to facilitate and to perfect the laying process, internal and external angles, plugs and junctions are recommended.

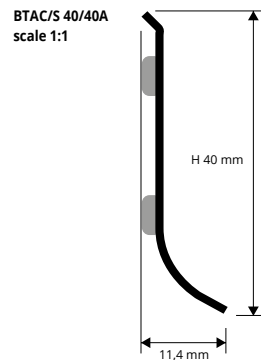

**POLISHED STAINLESS STEEL AISI 304/1.4301-V2A with protective film** - bar length 2 lm - pack. 25 Pcs - 50 lm

| Article                    | H mm | €/lm | €/Pc  |
|----------------------------|------|------|-------|
| BTAC 40A (with adhesive)   | 40   | 8,35 | 16,70 |
| BTAC 40 (without adhesive) | 40   | 7,61 | 15,22 |



**SATINED STAINLESS STEEL AISI 304/1.4301-V2A with protective film** - bar length 2 lm - pack. 25 Pcs - 50 lm

| Article                     | H mm | €/lm | €/Pc  |
|-----------------------------|------|------|-------|
| BTACS 40A (with adhesive)   | 40   | 9,73 | 19,46 |
| BTACS 40 (without adhesive) | 40   | 8,89 | 17,78 |

### COLOURS



SUITABLE FOR USE IN CONTACT WITH FOODSTUFFS

### EXAMPLES OF LAYING

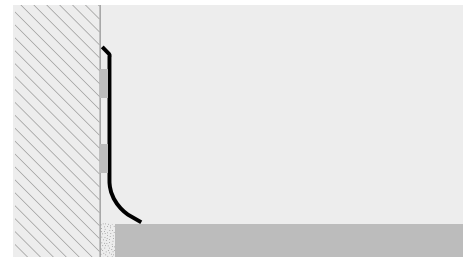

### LAYING INSTRUCTIONS

1. Choose the "SKIRTING 40" also choose with or without adhesive. 2. Cut the profile to the required length, taking care to calculate the width of the inside-outside corner joints. 3. For the self-adhesive version, the surface must be smooth, grease-free and not porous. It is not recommended for plaster and mortar surfaces (version without adhesive is better, using fast-setting acrylic silicone which is suitable for fixing aluminium to mortar - plaster, etc.). 4. Use the corner linking elements-joints and right and left end caps to facilitate laying.

## SKIRTING 40

ANODIZED, POLISHED, VARNISHED and BRUSHED ALUMINIUM

**SKIRTING 40** made in anodized, polished and brushed aluminium in height 40 mm. Available with or without adhesive. Superior aesthetic quality and easy to lay, it is ideal for all public and private environments. Can be used with all types of flooring. In order to facilitate and to perfect the laying process, internal and external angles, plugs and junctions are recommended. Please contact the technical department for informations concerning the skirting bending radius.



**ANODIZED SILVER ALUMINIUM thermo packed** bar length 2 lm - pack. 40 Pcs - 80 lm

| Article                    | H mm | €/lm | €/Pc  |
|----------------------------|------|------|-------|
| BTAA 40A (with adhesive)   | 40   | 6,66 | 13,32 |
| BTAA 40 (without adhesive) | 40   | 5,82 | 11,64 |

**POLISHED TITANIUM ALUMINIUM thermo packed** bar length 2 lm - pack. 40 Pcs - 80 lm

| Article                    | H mm | €/lm | €/Pc  |
|----------------------------|------|------|-------|
| BTBT 40A (with adhesive)   | 40   | 9,73 | 19,46 |
| BTBT 40 (without adhesive) | 40   | 8,67 | 17,34 |

**VARNISHED SEMIGLOSSY AND MATT WHITE ALUMINIUM thermo packed** - bar length 2 lm - pack. 40 Pcs - 80 lm

| Article                       | H mm | €/lm | €/Pc  |
|-------------------------------|------|------|-------|
| BTA 40-01A (with adhesive)    | 40   | 7,99 | 15,98 |
| BTA 40-01 (without adhesive)  | 40   | 6,98 | 13,96 |
| BTA 40-010A (with adhesive)   | 40   | 7,99 | 15,98 |
| BTA 40-010 (without adhesive) | 40   | 6,98 | 13,96 |

### COLOURS



**BRUSHED ALUMINIUM (silver-copper-titanium) thermo packed** - bar length 2 lm - pack. 40 Pcs - 80 lm

| Article                    | H mm | €/lm  | €/Pc  |
|----------------------------|------|-------|-------|
| BTBS 40A (with adhesive)   | 40   | 9,73  | 19,46 |
| BTBS 40 (without adhesive) | 40   | 8,67  | 17,34 |
| BTRS 40A (with adhesive)   | 40   | 10,79 | 21,58 |
| BTRS 40 (without adhesive) | 40   | 9,73  | 19,46 |
| BTTS 40A (with adhesive)   | 40   | 10,79 | 21,58 |
| BTTS 40 (without adhesive) | 40   | 9,73  | 19,46 |

(There aren't combinations for the finish alu. RS)

On demand may be realised in other finishes of the colour chart. Contact our customer service for minimum quantity, timing and price.

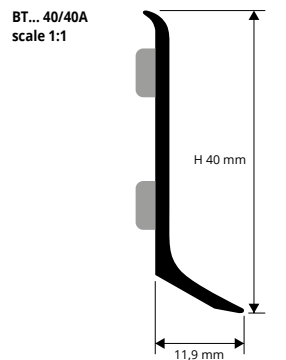

### EXAMPLES AND INSTRUCTIONS FOR LAYING METHODS



1. Choose the "SKIRTING 40" also choose with or without adhesive. 2. Cut the profile to the required length, taking care to calculate the width of the inside-outside corner joints. 3. For the self-adhesive version, the surface must be smooth, grease-free and not porous. It is not recommended for plaster and mortar surfaces (version without adhesive is better, using fast-setting acrylic silicone which is suitable for fixing aluminium to mortar - plaster, etc.). 4. Use the corner linking elements-joints and right and left end caps to facilitate laying.

## CORNERS, END CAPS AND JOINTS

STEEL and VARNISHED METAL

**VARNISHED METAL - EDGE COVER CORNERS** - articles not for sale singly

**INTERNAL/EXTERNAL CORNER - EDGE COVER VARNISHED METAL POLISHED STEEL EFFECT**

| Article                   | HxL mm  | €/Pc  | €/pack. 2Pcs | €/pack. 5Pcs |
|---------------------------|---------|-------|--------------|--------------|
| RIZCTAC 40/... (internal) | 40 x 20 | 10,54 | 23,19        | 52,70        |
| REZCTAC 40/... (external) | 40 x 20 | 10,54 | 23,19        | 52,70        |

**JOINT - EDGE COVER VARNISHED METAL POLISHED STEEL EFFECT**

| Article        | H mm | €/Pc  | €/pack. 2Pcs | €/pack. 5Pcs |
|----------------|------|-------|--------------|--------------|
| GIZCTAC 40/... | 40   | 10,23 | 22,51        | 51,15        |

Choose the desired packaging.  
E.g.: RIZCTAC 40/2 (pack. 2 pcs) - RIZCTAC 40/5 (pack. 5 pcs)

**END CAPS R / L - EDGE COVER - VARNISHED METAL POLISHED STEEL EFFECT** - pack. 4Pcs (2 R + 2 L) / 10Pcs (5 R + 5 L)

| Article        | H mm | €/Pc  | €/pack. 4Pcs | €/pack. 10Pcs |
|----------------|------|-------|--------------|---------------|
| TPZCTAC 40/... | 40   | 10,23 | 45,01        | 102,30        |

Choose the desired packaging.  
E.g.: TPZCTAC 40/2 (pack. 4 pcs: 2 right + 2 left)  
TPZCTAC 40/5 (pack. 10 pcs: 5 right + 5 left)

**STEEL AISI 304/1.4301-V2A - FLUSH CORNERS** - articles not for sale singly

**INTERNAL/EXTERNAL CORNER FLUSH PRE-WELDED - POLISHED STEEL EFFECT**

| Article                | HxL mm  | €/Pc  | €/pack. 2Pcs | €/pack. 5Pcs |
|------------------------|---------|-------|--------------|--------------|
| RIAC 40/... (internal) | 40 x 50 | 16,77 | 36,89        | 83,85        |
| REAC 40/... (external) | 40 x 50 | 16,77 | 36,89        | 83,85        |

Choose the desired packaging.  
E.g.: RIAC 40/2 (pack. 2 pcs) - RIAC 40/5 (pack. 5 pcs)

**INTERNAL/EXTERNAL CORNER - EDGE COVER VARNISHED METAL SATINED STAINLESS ST. EFFECT**

| Article                    | HxL mm  | €/Pc  | €/pack. 2Pcs | €/pack. 5Pcs |
|----------------------------|---------|-------|--------------|--------------|
| RIZCTACS 40/... (internal) | 40 x 20 | 10,54 | 23,19        | 52,70        |
| REZCTACS 40/... (external) | 40 x 20 | 10,54 | 23,19        | 52,70        |

**JOINT - EDGE COVER VARNISHED METAL SATINED STAINLESS ST. EFFECT**

| Article         | H mm | €/Pc  | €/pack. 2Pcs | €/pack. 5Pcs |
|-----------------|------|-------|--------------|--------------|
| GIZCTACS 40/... | 40   | 10,23 | 22,51        | 51,15        |

Choose the desired packaging.  
E.g.: RIZCTACS 40/2 (pack. 2 pcs) - RIZCTACS 40/5 (pack. 5 pcs)

**END CAPS R / L - EDGE COVER - VARNISHED METAL SATINED STAINLESS ST. EFFECT** - pack. 4Pcs (2 R + 2 L) / 10Pcs (5 R + 5 L)

| Article         | H mm | €/Pc  | €/pack. 4Pcs | €/pack. 10Pcs |
|-----------------|------|-------|--------------|---------------|
| TPZCTACS 40/... | 40   | 10,23 | 45,01        | 102,30        |

Choose the desired packaging.  
E.g.: TPZCTACS 40/2 (pack. 4 pcs: 2 right + 2 left)  
TPZCTACS 40/5 (pack. 10 pcs: 5 right + 5 left)

**INTERNAL/EXTERNAL CORNER FLUSH PRE-WELDED - SATINED STAINLESS STEEL**

| Article                 | HxL mm  | €/Pc  | €/pack. 2Pcs | €/pack. 5Pcs |
|-------------------------|---------|-------|--------------|--------------|
| RIACS 40/... (internal) | 40 x 50 | 17,77 | 39,09        | 88,85        |
| REACS 40/... (external) | 40 x 50 | 17,77 | 39,09        | 88,85        |

Choose the desired packaging.  
E.g.: RIACS 40/2 (pack. 2 pcs) - RIACS 40/5 (pack. 5 pcs)

## CORNERS, END CAPS AND JOINTS

VARNISHED METAL and VARNISHED PLASTIC

**VARNISHED METAL - EDGE COVER CORNERS** - articles not for sale singly

**INTERNAL/EXTERNAL CORNER - EDGE COVER VARNISHED METAL ANODIZED, POLISHED**

| Article                    | HxL mm  | €/Pc  | €/pack. 2Pcs | €/pack. 5Pcs |
|----------------------------|---------|-------|--------------|--------------|
| RIZCTAA 40/... (internal)  | 40 x 20 | 5,08  | 11,18        | 25,40        |
| REZCTAA 40/... (external)  | 40 x 20 | 5,08  | 11,18        | 25,40        |
| RIZCTBT 40/... (internal)  | 40 x 20 | 10,54 | 23,19        | 52,70        |
| REZCTBT 40/... (external)  | 40 x 20 | 10,54 | 23,19        | 52,70        |
| RIZCTBS 40/... (internal)  | 40 x 20 | 10,54 | 23,19        | 52,70        |
| REZCTBS 40/... (external)  | 40 x 20 | 10,54 | 23,19        | 52,70        |
| RIZCTRS 40/... (internal)  | 40 x 20 | 10,54 | 23,19        | 52,70        |
| REZCTRS 40/... (external)  | 40 x 20 | 10,54 | 23,19        | 52,70        |
| RIZCTTS 40/... (internal)  | 40 x 20 | 10,54 | 23,19        | 52,70        |
| REZCTTS 40/... (external)  | 40 x 20 | 10,54 | 23,19        | 52,70        |
| RIZCTO1 40/... (internal)  | 40 x 20 | 10,23 | 22,51        | 51,15        |
| REZCTO1 40/... (external)  | 40 x 20 | 10,23 | 22,51        | 51,15        |
| RIZCTO10 40/... (internal) | 40 x 20 | 10,23 | 22,51        | 51,15        |
| REZCTO10 40/... (external) | 40 x 20 | 10,23 | 22,51        | 51,15        |

Choose the desired packaging.  
E.g.: RIZCTAA 40/2 (pack. 2 pcs) - RIZCTAA 40/5 (pack. 5 pcs)

**JOINT - EDGE COVER VARNISHED METAL ANODIZED, POLISHED**

| Article        | H mm | €/Pc  | €/pack. 2Pcs | €/pack. 5Pcs |
|----------------|------|-------|--------------|--------------|
| GIZCTAA 40/... | 40   | 5,08  | 11,18        | 25,40        |
| GIZCTBT 40/... | 40   | 10,23 | 22,51        | 51,15        |
| GIZCTBS 40/... | 40   | 10,23 | 22,51        | 51,15        |
| GIZCTRS 40/... | 40   | 10,23 | 22,51        | 51,15        |
| GIZCTTS 40/... | 40   | 10,23 | 22,51        | 51,15        |
| GIZCTO1 40/... | 40   | 10,23 | 22,51        | 51,15        |

**END CAPS R / L - EDGE COVER - VARNISHED METAL ANODIZED, POLISHED** - pack. 4Pcs (2 R + 2 L) / 10Pcs (5 R + 5 L)

| Article       | H mm | €/Pc  | €/pack. 4Pcs | €/pack. 10Pcs |
|---------------|------|-------|--------------|---------------|
| TPZCTAA 40/3  | 40   | 5,08  | 22,35        | 50,80         |
| TPZCTBT 40/3  | 40   | 10,23 | 45,01        | 102,30        |
| TPZCTBS 40/3  | 40   | 10,23 | 45,01        | 102,30        |
| TPZCTRS 40/3  | 40   | 10,23 | 45,01        | 102,30        |
| TPZCTTS 40/3  | 40   | 10,23 | 45,01        | 102,30        |
| TPZCTO1 40/3  | 40   | 10,23 | 45,01        | 102,30        |
| TPZCTO10 40/3 | 40   | 10,23 | 45,01        | 102,30        |

**VARNISHED PLASTIC - EDGE COVER CORNERS** - articles not for sale singly

**INTERNAL/EXTERNAL CORNER - EDGE COVER VARNISHED PLASTIC ANODIZED SILVER, POLISHED AND TITANIUM**

| Article                  | HxL mm  | €/Pc | €/pack. 2Pcs | €/pack. 5Pcs |
|--------------------------|---------|------|--------------|--------------|
| RICTAA 40/... (internal) | 40 x 20 | 3,32 | 7,30         | 16,60        |
| RECTAA 40/... (external) | 40 x 20 | 3,32 | 7,30         | 16,60        |
| RICTBT 40/... (internal) | 40 x 20 | 5,08 | 11,18        | 25,40        |
| RECTBT 40/... (external) | 40 x 20 | 5,08 | 11,18        | 25,40        |

Choose the desired packaging.  
E.g.: RICTAA 40/2 (pack. 2 pcs) - RICTAA 40/5 (pack. 5 pcs)

**JOINT - EDGE COVER VARNISHED PLASTIC ANODIZED SILVER, POLISHED AND TITANIUM**

| Article       | H mm | €/Pc | €/pack. 2Pcs | €/pack. 5Pcs |
|---------------|------|------|--------------|--------------|
| GICTAA 40/... | 40   | 3,32 | 7,30         | 16,60        |
| GICTBT 40/... | 40   | 5,08 | 11,18        | 25,40        |

**END CAPS R / L - EDGE COVER - VARNISHED PLASTIC ANODIZED SILVER, POLISHED AND TITANIUM** - pack. 4Pcs (2 R + 2 L) / 10Pcs (5 R + 5 L)

| Article       | H mm | €/Pc | €/pack. 4Pcs | €/pack. 10Pcs |
|---------------|------|------|--------------|---------------|
| TPCTAA 40/... | 40   | 3,32 | 14,61        | 33,20         |
| TPCTBT 40/... | 40   | 5,08 | 22,35        | 50,80         |

© = News 2019

\* = Production on demand with minimum quantity of 100 pcs. Delivery time 4/5 weeks, price to agree

Prices are referred to whole packs, 10% increase for minimum orders of 10 pcs, 20% increase for orders of less than 10 pcs.





# SKIRTING 80

POLISHED AND SATINED STAINLESS STEEL AISI 304/1.4301-V2A

**SKIRTING 80** made in stainless steel AISI 304/1.4301-V2A in height 80 mm. Available with or without adhesive. Superior aesthetic quality, extremely strong and easy to lay, it is ideal for all public and private environments that require high standards of hygiene and image. Used increasingly more often in contrast combinations with wood, carpeted floors, etc. for an unmistakable hi-tech effect. In order to facilitate and to perfect the laying process, internal and external angles, plugs and junctions are recommended.

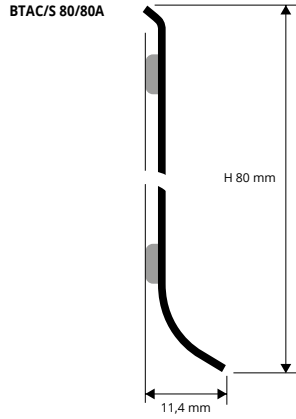

**POLISHED STAINLESS STEEL AISI 304/1.4301-V2 with protective film** - bar length 2 lm - pack. 25 Pcs - 50 lm

| Article                    | H mm | €/lm  | €/Pc  |
|----------------------------|------|-------|-------|
| BTAC 80A (with adhesive)   | 80   | 15,98 | 31,96 |
| BTAC 80 (without adhesive) | 80   | 14,28 | 28,56 |

**SATINED STAINLESS STEEL AISI 304/1.4301-V2A with protective film** - bar length 2 lm - pack. 25 Pcs - 50 lm

| Article                     | H mm | €/lm  | €/Pc  |
|-----------------------------|------|-------|-------|
| BTACS 80A (with adhesive)   | 80   | 18,25 | 36,50 |
| BTACS 80 (without adhesive) | 80   | 16,87 | 33,74 |

EXAMPLES OF LAYING

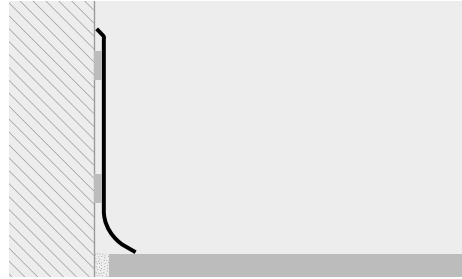

**LAYING INSTRUCTIONS**  
 1. Choose the "SKIRTING 80" also choose with or without adhesive. 2. Cut the profile to the required length, taking care to calculate the width of the inside-external corner joints. 3. For the self-adhesive version, the surface must be smooth, grease-free and not porous. It is not recommended for plaster and mortar surfaces (version without adhesive is better, using fast-setting acrylic silicone which is suitable for fixing aluminium to mortar - plaster, etc.). 4. Use the corner linking elements-joints and right and left end caps to facilitate laying.

**COLOURS**

|   |   |
|---|---|
| AC - Polished stainless steel AISI 304/1.4301-V2A | ACS - Satined stainless steel AISI 304/1.4301-V2A |
|---|---|

SUITABLE FOR USE IN CONTACT WITH FOODSTUFFS

# CORNERS, END CAPS AND JOINTS

STEEL and VARNISHED METAL

**VARNISHED METAL - EDGE COVER CORNERS** - articles not for sale singly

| Article                   | HxL mm  | €/Pc  | €/pack. 2Pcs | €/pack. 5Pcs |
|---------------------------|---------|-------|--------------|--------------|
| RIZCTAC 80/... (internal) | 80 x 20 | 10,54 | 23,19        | 52,70        |
| REZCTAC 80/... (external) | 80 x 20 | 10,54 | 23,19        | 52,70        |

**INTERNAL/EXTERNAL CORNER - EDGE COVER VARNISHED METAL SATINED STAINLESS ST. EFFECT**

| Article                    | HxL mm  | €/Pc  | €/pack. 2Pcs | €/pack. 5Pcs |
|----------------------------|---------|-------|--------------|--------------|
| RIZCTACS 80/... (internal) | 80 x 20 | 10,54 | 23,19        | 52,70        |
| REZCTACS 80/... (external) | 80 x 20 | 10,54 | 23,19        | 52,70        |

**JOINT - EDGE COVER VARNISHED METAL SATINED STAINLESS ST. EFFECT**

| Article    | H mm | €/Pc  | €/pack. 2Pcs | €/pack. 5Pcs |
|------------|------|-------|--------------|--------------|
| GIZCTAC 80 | 80   | 10,23 | 22,51        | 51,15        |

Choose the desired packaging. E.g.: RIZCTAC 80/2 (pack. 4 pcs: 2 right + 2 left) - RIZCTAC 80/5 (pack. 5 pcs)

  

**END CAPS R / L - EDGE COVER - VARNISHED METAL SATINED STAINLESS ST. EFFECT** - pack. 4Pcs (2 R + 2 L) / 10Pcs (5 R + 5 L)

| Article        | H mm | €/Pc  | €/pack. 4Pcs | €/pack. 10Pcs |
|----------------|------|-------|--------------|---------------|
| TPZCTAC 80/... | 80   | 10,23 | 45,01        | 102,30        |

Choose the desired packaging. E.g.: TPZCTAC 80/2 (pack. 4 pcs: 2 right + 2 left) - TPZCTAC 80/5 (pack. 10 pcs: 5 right + 5 left)

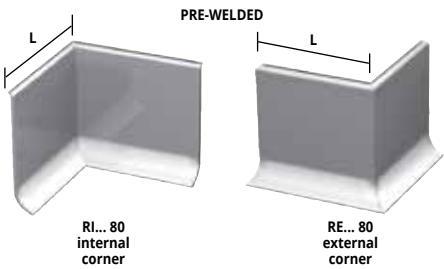
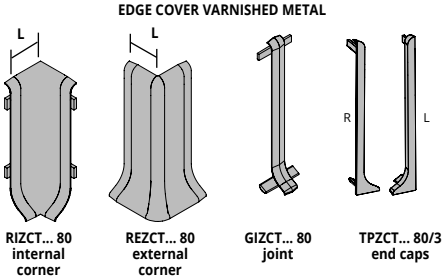

**STEEL AISI 304/1.4301-V2A - FLUSH CORNERS** - articles not for sale singly

| INTERNAL/EXTERNAL CORNER FLUSH PRE-WELDED - POLISHED STEEL EFFECT |         |       |              |              |
|---|---------|-------|--------------|--------------|
| Article   | HxL mm  | €/Pc  | €/pack. 2Pcs | €/pack. 5Pcs |
| RIAC 80/... (internal)  | 80 x 50 | 20,05 | 44,11        | 100,25       |
| REAC 80/... (external)  | 80 x 50 | 20,05 | 44,11        | 100,25       |

| INTERNAL/EXTERNAL CORNER FLUSH PRE-WELDED - SATINED STAINLESS STEEL |         |       |              |              |
|---|---------|-------|--------------|--------------|
| Article   | HxL mm  | €/Pc  | €/pack. 2Pcs | €/pack. 5Pcs |
| RIACS 80/... (internal)   | 80 x 50 | 21,05 | 46,31        | 105,25       |
| REACS 80/... (external)   | 80 x 50 | 21,05 | 46,31        | 105,25       |

Choose the desired packaging. E.g.: RIAC 80/2 (pack. 2 pcs) - RIAC 80/5 (pack. 5 pcs)

# SKIRTING 80

ANODIZED, POLISHED, VARNISHED and BRUSHED ALUMINIUM

**SKIRTING 80** made in anodized, polished and brushed aluminium in height 80 mm. Available with or without adhesive. Superior aesthetic quality and easy to lay, it is ideal for all public and private environments. Can be used with all types of flooring. In order to facilitate and to perfect the laying process, internal and external angles, plugs and junctions are recommended. Please contact the technical department for informations concerning the skirting bending radius.



**ANODIZED SILVER ALUMINIUM thermo packed**  
 bar length 2 lm - pack. 25 Pcs - 50 lm

| Article                    | H mm | €/lm  | €/Pc  |
|----------------------------|------|-------|-------|
| BTAA 80A (with adhesive)   | 80   | 10,73 | 21,46 |
| BTAA 80 (without adhesive) | 80   | 9,09  | 18,18 |

**BRUSHED ALUMINIUM (silver-copper-titanium) thermo packed** - bar length 2 lm - pack. 25 Pcs - 50 lm

| Article                    | H mm | €/lm  | €/Pc  |
|----------------------------|------|-------|-------|
| BTBS 80A (with adhesive)   | 80   | 14,71 | 29,42 |
| BTBS 80 (without adhesive) | 80   | 12,91 | 25,82 |
| BTRS 80A (with adhesive)   | 80   | 17,77 | 35,54 |
| BTRS 80 (without adhesive) | 80   | 16,18 | 32,36 |
| BTTS 80A (with adhesive)   | 80   | 17,77 | 35,54 |
| BTTS 80 (without adhesive) | 80   | 16,18 | 32,36 |

**POLISHED TITANIUM ALUMINIUM thermo packed**  
 bar length 2 lm - pack. 25 Pcs - 50 lm

| Article                    | H mm | €/lm  | €/Pc  |
|----------------------------|------|-------|-------|
| BTBT 80A (with adhesive)   | 80   | 14,71 | 29,42 |
| BTBT 80 (without adhesive) | 80   | 12,91 | 25,82 |

**VARNISHED SEMIGLOSSY AND MATT WHITE ALUMINIUM thermo packed** - bar length 2 lm - pack. 25 Pcs - 50 lm

| Article                       | H mm | €/lm  | €/Pc  |
|-------------------------------|------|-------|-------|
| BTA 80-01A (with adhesive)    | 80   | 12,88 | 25,76 |
| BTA 80-01 (without adhesive)  | 80   | 10,92 | 21,84 |
| BTA 80-010A (with adhesive)   | 80   | 12,88 | 25,76 |
| BTA 80-010 (without adhesive) | 80   | 10,92 | 21,84 |

**COLOURS**

| SEMIGLOSSY                        | MATT  |
|-----------------------------------|---|
| 01 - White varnished alum. (9016) | 010 - White varnished alum. (9016)                    |
| ANODIZED                          | POLISHED  |
| AA - Anodized silver alum.        | BT - Polished titanium alum.                          |
|                                   | BRUSHED   |
| BS - Brushed silver alum.         | TS - Brushed titanium alum. RS - Brushed copper alum. |

Available on demand aluminium prewelded internal and external flush corners. Finishing: 01 - 010 - AA - BT - BS - RS - TS. Price and delivery time to be agreed.

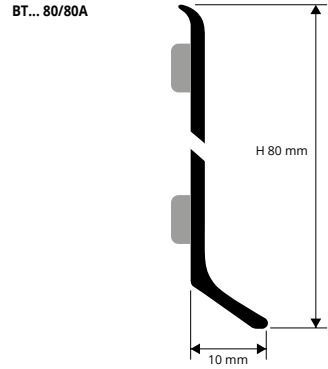

EXAMPLES AND INSTRUCTIONS FOR LAYING METHODS

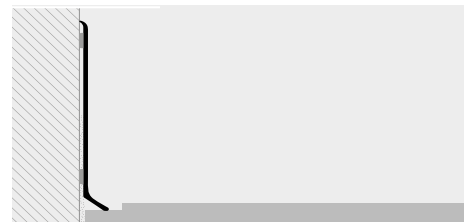

# CORNERS, END CAPS AND JOINTS

VARNISHED METAL and VARNISHED PLASTIC

**VARNISHED METAL - EDGE COVER CORNERS** - articles not for sale singly

**INTERNAL/EXTERNAL CORNER - EDGE COVER VARNISHED METAL ANODIZED, POLISHED**

| Article                    | HxL mm  | €/Pc  | €/pack. 2Pcs | €/pack. 5Pcs |
|----------------------------|---------|-------|--------------|--------------|
| RIZCTAA 80/... (internal)  | 80 x 20 | 5,08  | 11,18        | 25,40        |
| REZCTAA 80/... (external)  | 80 x 20 | 5,08  | 11,18        | 25,40        |
| RIZCTBT 80/... (internal)  | 80 x 20 | 10,54 | 23,19        | 52,70        |
| REZCTBT 80/... (external)  | 80 x 20 | 10,54 | 23,19        | 52,70        |
| RIZCTBS 80/... (internal)  | 80 x 20 | 10,54 | 23,19        | 52,70        |
| REZCTBS 80/... (external)  | 80 x 20 | 10,54 | 23,19        | 52,70        |
| RIZCTRS 80/... (internal)  | 80 x 20 | 10,54 | 23,19        | 52,70        |
| REZCTRS 80/... (external)  | 80 x 20 | 10,54 | 23,19        | 52,70        |
| RIZCTTS 80/... (internal)  | 80 x 20 | 10,54 | 23,19        | 52,70        |
| REZCTTS 80/... (external)  | 80 x 20 | 10,54 | 23,19        | 52,70        |
| RIZCTO1 80/... (internal)  | 80 x 20 | 10,23 | 22,51        | 51,15        |
| REZCTO1 80/... (external)  | 80 x 20 | 10,23 | 22,51        | 51,15        |
| RIZCTO10 80/... (internal) | 80 x 20 | 10,23 | 22,51        | 51,15        |
| REZCTO10 80/... (external) | 80 x 20 | 10,23 | 22,51        | 51,15        |

**JOINT - EDGE COVER VARNISHED METAL ANODIZED, POLISHED**

| Article         | H mm | €/Pc  | €/pack. 2Pcs | €/pack. 5Pcs |
|-----------------|------|-------|--------------|--------------|
| GIZCTAA 80/...  | 80   | 5,08  | 11,18        | 25,40        |
| GIZCTBT 80/...  | 80   | 10,23 | 22,51        | 51,15        |
| GIZCTBS 80/...  | 80   | 10,23 | 22,51        | 51,15        |
| GIZCTRS 80/...  | 80   | 10,23 | 22,51        | 51,15        |
| GIZCTTS 80/...  | 80   | 10,23 | 22,51        | 51,15        |
| GIZCTO1 80/...  | 80   | 10,23 | 22,51        | 51,15        |
| GIZCTO10 80/... | 80   | 10,23 | 22,51        | 51,15        |

**END CAPS R / L - EDGE COVER - VARNISHED METAL ANODIZED, POLISHED** - pack. 4Pcs (2 R + 2 L) / 10Pcs (5 R + 5 L)

| Article         | H mm | €/Pc  | €/pack. 4Pcs | €/pack. 10Pcs |
|-----------------|------|-------|--------------|---------------|
| TPZCTAA 80/...  | 80   | 5,08  | 22,35        | 50,80         |
| TPZCTBT 80/...  | 80   | 10,23 | 45,01        | 102,30        |
| TPZCTBS 80/...  | 80   | 10,23 | 45,01        | 102,30        |
| TPZCTRS 80/...  | 80   | 10,23 | 45,01        | 102,30        |
| TPZCTTS 80/...  | 80   | 10,23 | 45,01        | 102,30        |
| TPZCTO1 80/...  | 80   | 10,23 | 45,01        | 102,30        |
| TPZCTO10 80/... | 80   | 10,23 | 45,01        | 102,30        |

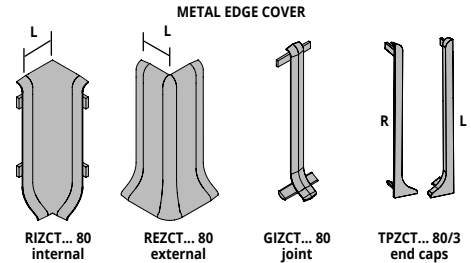

**VARNISHED PLASTIC - EDGE COVER CORNERS** - articles not for sale singly

**INTERNAL/EXTERNAL CORNER - EDGE COVER VARNISHED PLASTIC ANODIZED SILVER, POLISHED AND TITANIUM**

| Article                  | HxL mm  | €/Pc | €/pack. 2Pcs | €/pack. 5Pcs |
|--------------------------|---------|------|--------------|--------------|
| RICTAA 80/... (internal) | 80 x 20 | 3,32 | 7,30         | 16,60        |
| RECTAA 80/... (external) | 80 x 20 | 3,32 | 7,30         | 16,60        |
| RICTBT 80/... (internal) | 80 x 20 | 5,08 | 11,18        | 25,40        |
| RECTBT 80/... (external) | 80 x 20 | 5,08 | 11,18        | 25,40        |

**JOINT - EDGE COVER VARNISHED PLASTIC ANODIZED SILVER, POLISHED AND TITANIUM**

| Article       | H mm | €/Pc | €/pack. 2Pcs | €/pack. 5Pcs |
|---------------|------|------|--------------|--------------|
| GICTAA 80/... | 80   | 3,32 | 7,30         | 16,60        |
| GICTBT 80/... | 80   | 5,08 | 11,18        | 25,40        |

**END CAPS R / L - EDGE COVER - VARNISHED PLASTIC ANODIZED SILVER, POLISHED AND TITANIUM** - pack. 4Pcs (2 R + 2 L) / 10Pcs (5 R + 5 L)

| Article       | H mm | €/Pc | €/pack. 4Pcs | €/pack. 10Pcs |
|---------------|------|------|--------------|---------------|
| TPCTAA 80/... | 80   | 3,32 | 14,61        | 33,20         |
| TPCTBT 80/... | 80   | 5,08 | 22,35        | 50,80         |

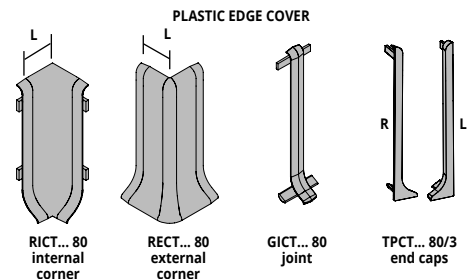

**VARNISHED PLASTIC - FLUSH CORNERS** - articles not for sale singly

**INTERNAL/EXTERNAL CORNER - FLUSH VARNISHED PLASTIC ANODIZED SILVER, POLISHED AND TITANIUM**

| Article                 | HxL mm  | €/Pc | €/pack. 2Pcs | €/pack. 5Pcs |
|-------------------------|---------|------|--------------|--------------|
| RIBAA 80/... (internal) | 80 x 25 | 3,32 | 7,30         | 16,60        |
| REBAA 80/... (external) | 80 x 25 | 3,32 | 7,30         | 16,60        |
| RIBBT 80/... (internal) | 80 x 25 | 5,08 | 11,18        | 25,40        |
| REBBT 80/... (external) | 80 x 25 | 5,08 | 11,18        | 25,40        |

**JOINT - FLUSH VARNISHED PLASTIC ANODIZED SILVER, POLISHED AND TITANIUM**

| Article      | H mm | €/Pc | €/pack. 2Pcs | €/pack. 5Pcs |
|--------------|------|------|--------------|--------------|
| GIBAA 80/... | 80   | 3,32 | 7,30         | 16,60        |
| GIBBT 80/... | 80   | 5,08 | 11,18        | 25,40        |

**END CAPS R / L - FLUSH - VARNISHED PLASTIC ANODIZED SILVER, POLISHED AND TITANIUM** - pack. 4Pcs (2 R + 2 L) / 10Pcs (5 R + 5 L)

| Article      | H mm | €/Pc | €/pack. 4Pcs | €/pack. 10Pcs |
|--------------|------|------|--------------|---------------|
| TPBAA 80/... | 80   | 3,32 | 14,61        | 33,20         |
| TPBBT 80/... | 80   | 5,08 | 22,35        | 50,80         |

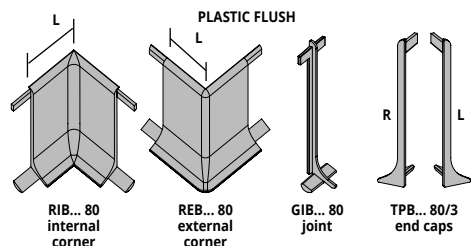

\* = Production on demand with minimum quantity of 100 pcs. Delivery time 4/5 weeks, price to agree

Prices are referred to whole packs, 10% increase for minimum orders of 10 pcs, 20% increase for orders of less than 10 pcs.





## SKIRTING 7016

FOAMED VINYL RESIN  
77 WOODEN FINISHES (53 on demand),  
AND 3 IN SOLID COLOUR

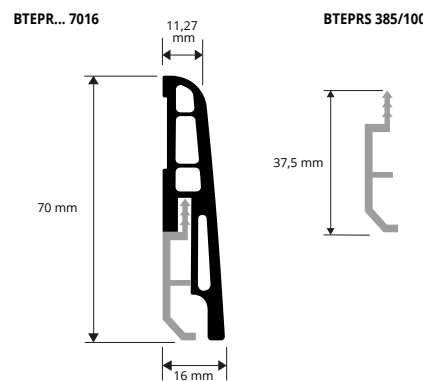

**EXAMPLES AND INSTRUCTIONS FOR LAYING METHODS**  
1. Choose "SKIRTING 7016" in the desired finish. 2. Fix the pre-punched support to the wall with screws every 50 cm. 3. Attach the profile to the support applying low pressure. 4. Alternatively fix the profile using a suitable fast adhesive, nails or screws

**SKIRTING 7016** is a vinyl resin foam profile with a height of 70 mm, available in the 77 wooden finishes (53 on demand) and 3 finishes in solid colour that could be matched with the PROINSERT SYSTEM's profiles. The profile, suitable like skirting for floating and glued wood floor, laminate and LVT, could be laid with suitable adhesive, nails, screws or using the pre-punched support fixed to the wall with screws every 50 cm. Its special section, that allows to cover a 16 mm perimetral joint, and wide range of finishes make it a very requested, elegant and economic skirting board profile.



**FOAMED VINYL RESIN (wood finishes - black - white and silver)**  
bar length 2,5 lm - pack. 20 Pcs - 50 lm

| Article       | H mm | €/lm | €/Pc |
|---------------|------|------|------|
| BTEPR... 7016 | 70   | 3,66 | 9,15 |

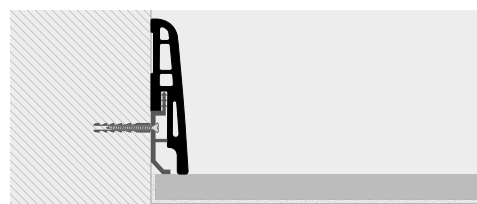

On request it is possible to realize other finishes of the color range: minimum order 100 pcs. Delivery time 4/5 weeks. Price to agreed. For sample finishes, contact the sales office for minimum quantities, timing and costs.



**SUPPORT / FIXING CLIP - PLASTIC**  
support length 5 cm - pack. 100 Pcs

| Article        | H mm | €/Pc | €/Pack. |
|----------------|------|------|---------|
| BTEPRS 385/100 | 37,5 | 0,10 | 10,00   |

Order the SUPPORT and choose the SKIRTING in the desired finish.

**IN/EXTERNAL CORNERS and END CAPS KIT (wood finishes - black - white and silver)**

| Article                           | H mm | €/KIT |
|-----------------------------------|------|-------|
| KIT BTEPR ...7016I (internal kit) | 70   | 9,22  |
| KIT BTEPR ...7016E (external kit) | 70   | 9,22  |

Available in the wood finishes: 04W-05W-13W-18W-21W-25W-29W-30W-31W-32W-33W-34W-35W-36W-37W-38W-39W-41W-42W-44W-45W-53W-54W-55W-B-N-AA.  
The code of the selected colour must be added to the article code.  
E.g.: BTEPR... 7016 (chosen finish Dark beech) BTEPR04W 7016

## SKIRTING 7011

FOAMED VINYL RESIN  
77 WOODEN FINISHES (50 on demand),  
AND 3 IN SOLID COLOUR

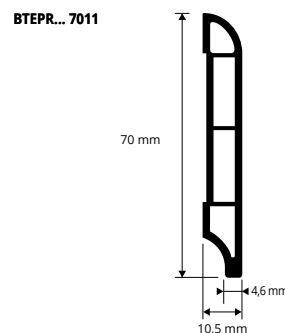

**EXAMPLES AND INSTRUCTIONS FOR LAYING METHODS**

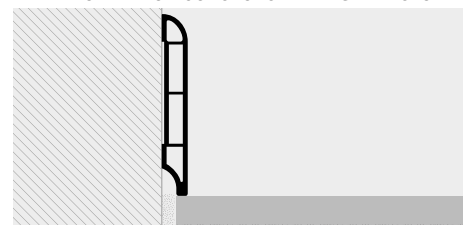

1. Choose the "SKIRTING 7011" in the required the colour. 2. Lay the "SKIRTING 7011" using quick-setting suitable adhesive for gluing flexible PVC onto mortar-plaster-accessorised walls, etc. or fix with nails.

**SKIRTING 7011** is a vinyl resin foam profile with a height of 70 mm x 10,5mm, available in the 77 wooden finishes (50 on demand) and 3 finishes standard colours that could be matched with the PROINSERT SYSTEM's profiles. Suitable as skirting/Basebord for floating and glued wood floor, laminate and LVT, could be laid with suitable adhesive, or else with nails.



**FOAMED VINYL RESIN (wood finishes - black - white and silver)**  
bar length 2,5 lm - pack. 20 Pcs - 50 lm

| Article       | H mm | €/lm | €/Pc |
|---------------|------|------|------|
| BTEPR... 7011 | 70   | 3,50 | 8,75 |

**COLOURS** (For a precise assessment of colours request the wood finishes sample range)

|                         |                            |  |                    |                  |                     |                 |                    |                 |                  |
|-------------------------|----------------------------|--|--------------------|------------------|---------------------|-----------------|--------------------|-----------------|------------------|
| 05W - Light oak (strip) | 07W - Light cherry (strip) | 09W - Red walnut (merbau-apple-walnut) | 18W - Light Zebano | 21W - Powder Oak | 29W - White oak     | 30W - Gray oak  | 31W - Victoria oak | 32W - Pink oak  | 34W - Havana oak |
| 35W - Edimburgo oak     | 37W - Canvi oak            | 40W - Brown oak                        | 41W - Ice oak      | 42W - Grace oak  | 43W - Manhattan oak | 44W - Honey oak | 46W - Black decape | 47W - Black oak | 48W - Cork oak   |
| 49W - Sand oak          | 65W - Tripoli              | 73W - Bangkok                          | 75W - Lotard       | 69W              | 71W                 | 72W             | B - White          | N - Black       | AA - Silver      |

On request it is possible to realize other finishes of the color range: minimum order 100 pcs. Delivery time 4/5 weeks. Price to agreed. For sample finishes, contact the sales office for minimum quantities, timing and costs.

## IN/EXTERNAL CORNERS and END CAPS KIT

FOAMED VINYL RESIN 77 WOODEN FINISHES (50 on demand), AND 3 IN SOLID COLOUR

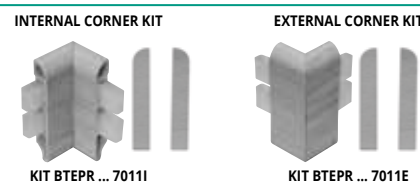

**IN/EXTERNAL CORNERS and END CAPS KIT (wood finishes - black - white and silver)**

| Article                           | H mm | €/KIT |
|-----------------------------------|------|-------|
| KIT BTEPR ...7011I (internal kit) | 70   | 8,19  |
| KIT BTEPR ...7011E (external kit) | 70   | 8,19  |

The kits are composed respectively by 1 inside corner + two end caps and 1 outside corner + two end caps.  
Available in the wood finishes: 05W-07W-09W-18W-21W-29W-30W-31W-32W-34W-35W-37W-40W-41W-42W-43W-44W-46W-47W-48W-49W-65W-73W-75W-69W-71W-72W-B-N-AA.  
The code of the selected colour must be added to the article code.  
E.g.: KIT BTEPR ...7011I (chosen finish Light oak) KIT BTEPR04W 7011I

Prices are referred to whole packs, 10% increase for minimum orders of 10 pcs, 20% increase for orders of less than 10 pcs.

**SKIRTING** in PVC foam height 70 mm in 4 semi-matt colours and 8 wood finishes to be matched with the PROINSERT SYSTEM profiles for floating laminated wood floors and traditional parquet floors. Laying is done by gluing (acetic silicone -acrylic-mastic) or using screws or nails. Attractive, strong, hardwearing and economic, it is easy to lay and ideal for many public premises (hospitals, schools, gymnasiums, rest homes and creative areas) and private environments.

## SKIRTING

EXPANDED VINYL RESIN



**EXPANDED RIGID VINYL RESIN (black - light and dark grey - white)**  
bar length 2 lm - pack. 60 Pcs - 120 lm

| Article    | H mm | €/lm | €/Pc | €/Pack. |
|------------|------|------|------|---------|
| BTPR... 70 | 70   | 1,00 | 2,00 | 120,00  |



**EXPANDED RIGID VINYL RESIN (8 wood finishes)**  
bar length 2 lm - pack. 60 Pcs - 120 lm

| Article    | H mm | €/lm | €/Pc | €/Pack. |
|------------|------|------|------|---------|
| BTPR... 70 | 70   | 1,05 | 2,10 | 126,00  |

Available in the wood finishes: B - GC - GS - N - 04W - 05W - 06W - 07W - 08W - 09W - 10W - M.  
The code of the selected colour must be added to the article code. E.g.: BTPR... 70 (chosen colour black) BTPRN 70.

The shade of the wooden finish in rigid expanded vinyl resin/PVC results slightly different from the film usually applied on the profiles in aluminium.

**COLOURS**

|                         |                            |                           |  |                                 |                         |
|-------------------------|----------------------------|---------------------------|--|---------------------------------|-------------------------|
| B - White               | GC - Light grey            | GS - Dark grey            | N - Black                              | 04W - Dark beech                | 05W - Light oak (strip) |
| 06W - Dark oak (walnut) | 07W - Light cherry (strip) | 08W - Dark cherry (board) | 09W - Red walnut (merbau-apple-walnut) | 10W - Wengé (panga panga-wengé) | M - Mogano              |

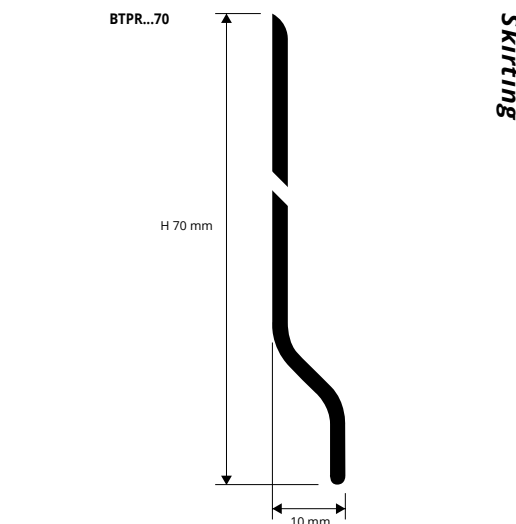

**EXAMPLES AND INSTRUCTIONS FOR LAYING METHODS**

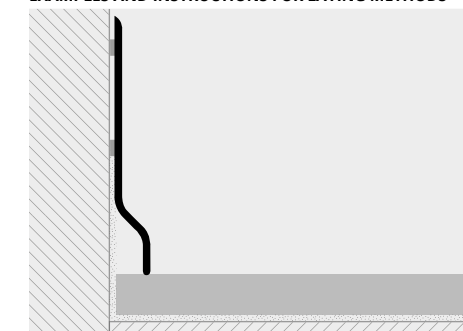

1. Choose the "SKIRTING" in the required the colour. 2. Lay the "SKIRTING" using quick-setting acrylic silicone, mastic or bostik, suitable for gluing flexible PVC onto mortar-plaster-accessorised walls, etc. or fix with screws/nails.

**ANGLE BAR** produced in expanded PVC in 4 semi-matt colours and 8 wood finishes used to protect angles. Laying is done by gluing (acetic silicone - acrylic-mastic) or using screws or nails. Attractive, strong, hardwearing and economic, it is easy to lay and ideal for many public premises (hospitals, schools, gymnasiums, rest homes and creative areas) and private environments.

## ANGLE BAR

EXPANDED VINYL RESIN



**EXPANDED RIGID VINYL RESIN (black - light and dark grey - white)**  
bar length 2,7 lm - pack. 40 Pcs - 108 lm

| Article   | L x H mm | €/lm | €/Pc |
|-----------|----------|------|------|
| AGE... 25 | 25 x 25  | 0,90 | 2,43 |



**EXPANDED RIGID VINYL RESIN (8 wood finishes)**  
bar length 2,7 lm - pack. 40 Pcs - 108 lm

| Article   | L x H mm | €/lm | €/Pc |
|-----------|----------|------|------|
| AGE... 25 | 25 x 25  | 0,92 | 2,48 |

Available in the wood finishes: B - GC - GS - N - 04W - 05W - 06W - 07W - 08W - 09W - 10W - M.  
The code of the selected colour must be added to the article code. E.g.: AGE... 25 (chosen finish black) AGEN 25.

The shade of the wooden finish in rigid expanded vinyl resin/PVC results slightly different from the film usually applied on the profiles in aluminium.

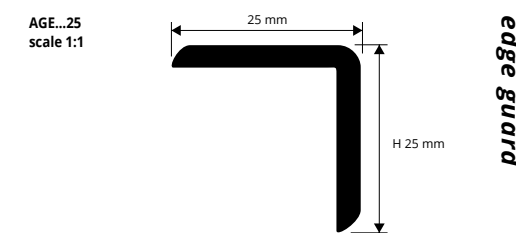

**EXAMPLES OF LAYING**

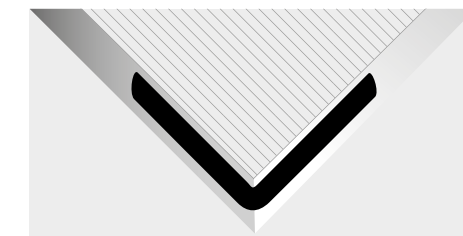

Prices are referred to whole packs, 10% increase for minimum orders of 10 pcs, 20% increase for orders of less than 10 pcs.



# SKIRTING 60 SKIRTING 120

NON-TOXIC FLEXIBLE VINYL RESIN  
IN 6 COLOURS

PVC FLEXIBLE SKIRTING 60/120 height 60 mm and 120 mm, is a very strong profile ideal for easily achieving special, attractive, superior finishes. Installation recommended with glue or silicone. Easy to install, the shaped edges ensure perfect adhesion to the surface. The projecting rounded flange covers the terminal expansion joint.

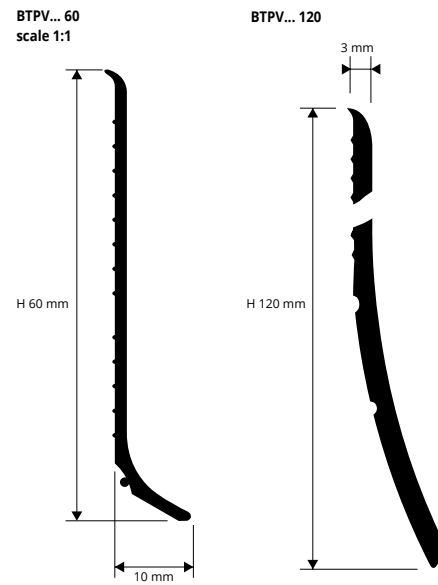

### EXAMPLES AND INSTRUCTIONS FOR LAYING METHODS

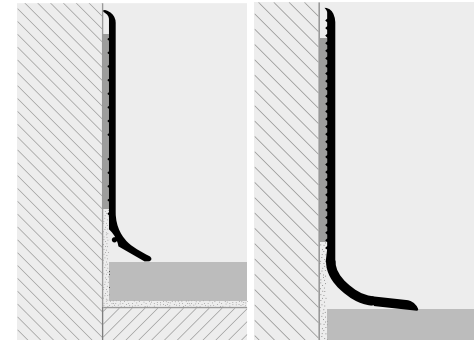

NON-TOXIC FLEXIBLE VINYL RESIN  
rolls length 50 lm

| Article                      | H mm | €/lm | €/roll |
|------------------------------|------|------|--------|
| BTPV... 60A (with adhesive)  | 60   | 2,83 | 141,50 |
| BTPV... 120A (with adhesive) | 120  | 6,39 | 319,50 |
| BTPV... 60                   | 60   | 1,69 | 84,50  |
| BTPV... 120                  | 120  | 4,02 | 201,00 |

Available in the colours: B - GC - GS - T - M - N.  
The code of the selected colour must be added to the article code.  
E.g.: BTPV... 60 (chosen finish light gray) BTPVGC 60.

### COLOURS

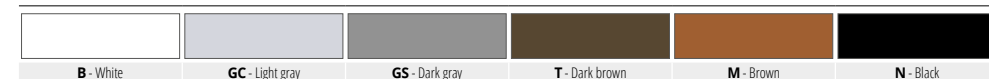

ATTENTION: IN ORDER TO USE, LAY AND FIX PROPERLY THIS PRODUCT PLEASE LOOK AT OUR WEBSITE OR APP LAYING / FIXING VIDEO FOR CORRECT INSTALLATION.



# SKIRTING 62F

FLEXIBLE VINYL RESIN  
IN 6 COLOURS

SKIRTING 62F is a new 62 mm skirting board made of non-toxic, flexible vinyl resin. This profile is very resistant and particularly suited for providing highly aesthetic perimeter skirting of excellent quality at reasonable prices. It differs from the BTPV... 60 skirting board in that it is provided with a bottom flange that allows it to be placed perpendicularly (90°) to the wall/lining and welded to PVC floors. In addition, the horizontal flange covers the floor's perimeter expansion joint. We recommend applying the skirting using glue/adhesive/Bostik/mastic. Alternatively, you can choose the self-adhesive version for quick, effortless installation.

BTPF... 62 / BTPF... 62A  
scale 1:1

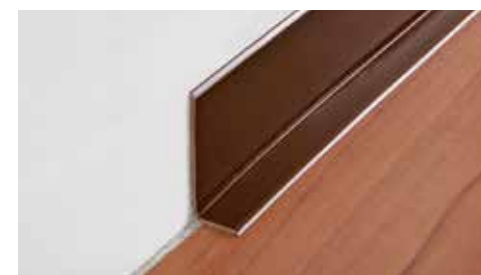
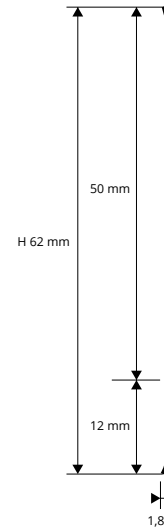

### EXAMPLES OF LAYING

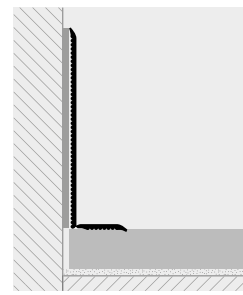

### LAYING INSTRUCTIONS

1. Choose the colour of the "SKIRTING 62F" board, indicating whether you want it with or without a self-adhesive backing. 2. Cut the "SKIRTING 62F" to length, taking into account the width of the internal and external connections. 3. Self-adhesive skirting is recommended only for surfaces that are perfectly smooth, non-oily and non-porous. On plaster and mortar surfaces, use a non-adhesive version and apply the skirting using quick-setting acrylic silicone suitable for gluing aluminium to mortar, plaster, etc.

ATTENTION: IN ORDER TO USE, LAY AND FIX PROPERLY THIS PRODUCT PLEASE LOOK AT OUR WEBSITE OR APP LAYING / FIXING VIDEO FOR CORRECT INSTALLATION



### FLEXIBLE VINYL RESIN

rolls length 50 lm with or without adhesive

| Article                       | H mm | €/lm | €/roll |
|-------------------------------|------|------|--------|
| BTPF... 62A (with adhesive)   | 62   | 2,70 | 135,00 |
| BTPF... 62 (without adhesive) | 62   | 1,59 | 79,50  |

Available in the colours: B - GC - GS - T - M - N.  
The code of the selected colour must be added to the article code.  
E.g.: BTPF...62 (chosen finish light gray) BTPF62G 62.

As regards the items with adhesive, the adhesive roll is sold separately (50 lm)

### COLOURS

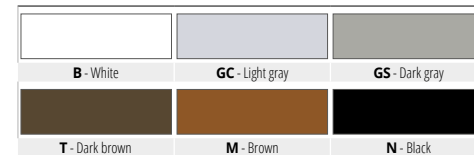

SKIRTING COVECAP is a series of flexible co-extruded non-toxic vinyl profiles. SKIRTING COVECAP is a SKIRTING/ BASEBOARD with capping seal used to provide an elegant and functional solution to finish the top of resilient floor covering where it has been covered up to the wall, support floor covering at a wall point and protects the exposed edges. The visible portion of the profiles is rounded and available in white - light grey - dark grey - dark brown - brown and black.

# SKIRTING COVECAP

NON-TOXIC FLEXIBLE CO-EXTRUDED VINYL RESIN



NON-TOXIC FLEXIBLE CO-EXTRUDED VINYL RESIN  
bar length 2,50 lm - pack. 20 / 30 / 40 Pcs - 50 / 75 / 100 lm

| Article            | H mm | €/lm | €/Pc  | €/Pack. |
|--------------------|------|------|-------|---------|
| BTVC... 60 (40pc)  | 60   | 3,81 | 9,53  | 381,20  |
| BTVC... 80 (30pc)  | 80   | 4,02 | 10,05 | 301,50  |
| BTVC... 100 (20pc) | 100  | 4,22 | 10,55 | 211,00  |

Available in the colours: B - GC - GS - T - M - N.  
The code of the selected colour must be added to the article code.  
E.g.: BTVC... 60 (chosen colour white) BTVC60.

### COLOURS - FLEXIBLE PART

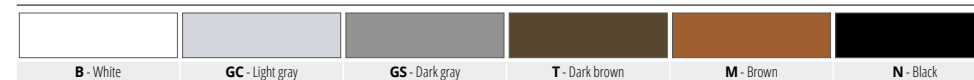

### EXAMPLES AND INSTRUCTIONS FOR LAYING METHODS

1. Select the "SKIRTING COVECAP" of the desired color and height. 2. Using a utility knife cut the "SKIRTING COVECAP" to the desired length. 3. Apply the proper adhesive or glue/mastic and install the profile.

ATTENTION: THE INSTALLATION OF THIS PROFILES IS RECOMMENDED FOR AN EXPERT INSTALLER OF VINYL FLOORINGS

Adhesive version: add the letter A after the article. As regards the items with adhesive, the adhesive roll is sold separately.

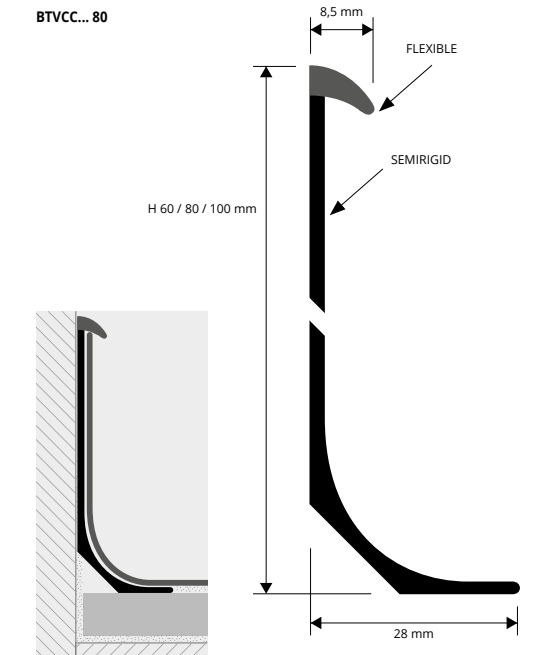

### SEMIRIGID



PROCAP is a non-toxic co-extruded flexible vinyl resin profile that in combination with PROSEAL FLEX allows a correct application and finishing of vinyl flooring and carpet along the wall-floor joint. The visible surface of the profile is available in white, light gray, dark gray, dark brown, brown and black. Its ease of application makes it a very practical profile for the finishing of vinyl and carpet flooring

# PROCAP S / L

NON-TOXIC CO-EXTRUDED FLEXIBLE VINYL RESIN

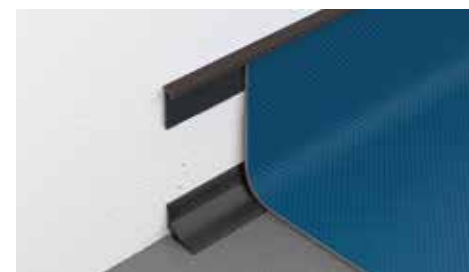

PROCAP S/L - NON-TOXIC FLEXIBLE CO-EXTRUDED VINYL RESIN  
bar length 2,50 - pack. 20 Pcs - 50 lm

| Article  | H x L mm | €/lm | €/Pc |
|----------|----------|------|------|
| PRCPS... | 31 x 5,3 | 1,55 | 3,88 |
| PRCPL... | 55 x 10  | 1,96 | 4,90 |

Available in the colours: B - GC - GS - T - M - N.  
The code of the selected colour must be added to the article code.  
E.g.: PRCPL... (chosen colour white) PRCPLB

### COLOURS

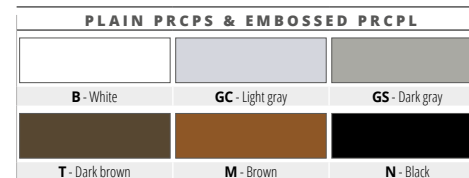

PROSEAL FLEX - FLEXIBLE BLACK NON-TOXIC VINYL RESIN  
bar length 2,5 lm - pack. 40 Pcs - 100 lm

| Article   | L X H mm | €/lm | €/Pc |
|-----------|----------|------|------|
| PSF 15-11 | 15x15    | 1,03 | 2,58 |
| PSF 20-11 | 20x20    | 1,24 | 3,10 |
| PSF 25-11 | 25x25    | 1,55 | 3,88 |

### EXAMPLES AND INSTRUCTIONS FOR LAYING METHODS

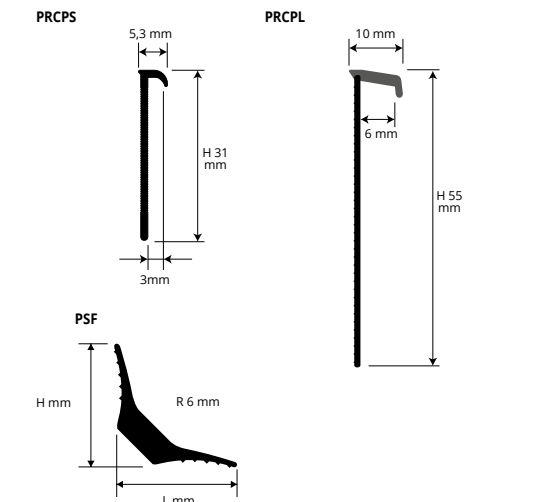
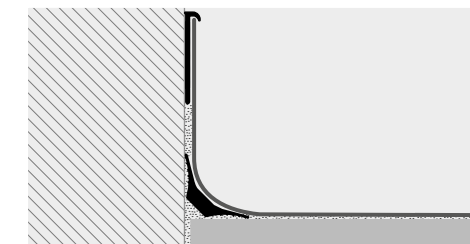

1. Choose "PROCAP S-L" according to height and desired colour. 2. Cut "PROCAP S-L" to the right length. 3. Apply a suitable adhesive and lay the profile. 4. Lay the desired resilient flooring.



# PROSEAL WOOD

EXPANDED PVC  
2 WOOD FINISHING AND 4 MATCHING COLOURS

**PROSEAL WOOD** is a new inner connector square suitable for creating a concave skirting for wood / rolled-melamine floating wood / ceramic / marble tiles to reduce the floor /covering detachment. The particular material used allows to resist to the main chemical agents ant to small breakages. **PROSEAL WOOD's** dimensions allow the necessary expansion of the outer joint. Ideal for public (schools, rest homes, recreational area) and private places. In expanded PVC , in 2 wood finishes 4 in matching colours to combine with various wood finishes. Easy to lay with fixing silicone.

transition profiles

PSAW... 20  
scale 1:1

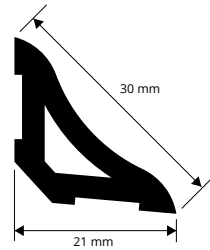

EXAMPLES AND INSTRUCTIONS FOR LAYING METHODS

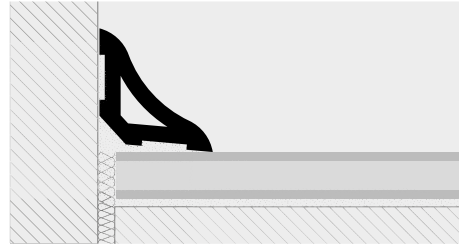

1. Choose "PROSEAL WOOD" color and/or wood finish required.
2. The laying must be carried out using fast fixing acrylic silicone, mastic, bostik suitable for glueing PVC with mortar - plaster - wall units etc., or fix using screws/nails.



**EXPANDED PVC - 2 WOOD FINISHING**  
bar length 2,5 lm - pack. 40 Pcs - 100 lm

| Article    | L x H mm | €/lm | €/Pc |
|------------|----------|------|------|
| PSAW... 20 | 21 x 21  | 0,77 | 1,93 |



**EXPANDED PVC - 4 COLOURS**  
bar length 2,5 lm - pack. 40 Pcs - 100 lm

| Article    | L x H mm | €/lm | €/Pc |
|------------|----------|------|------|
| PSAW... 20 | 21 x 21  | 0,72 | 1,80 |

Available in the wood finishes: 05W - 10W , and colours: B - GC - GS - N.  
The code of the selected colour must be added to the article code. E.g.: PSAW...20 (chosen finish black) PSAWN 20.

The shade of the wooden finish in rigid expanded vinyl resin/PVC results slightly different from the film usually applied on the profiles in aluminium.

COLOURS

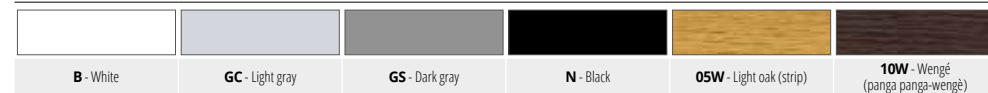

# PROANGLE WOOD

EXPANDED PVC  
2 WOOD FINISHING AND 4 MATCHING COLOURS

**PROANGLE WOOD** is a new inner connector square suitable for creating a convex skirting for wood / rolled-melamine floating wood / ceramic / marble floor to reduce the floor /covering detachment. The particular material used allows to resist to the main chemical agents and to small breakages. **PROANGLE WOOD's** dimensions allow the necessary expansion of the outer joint. Ideal for public (schools, rest homes, recreational area) and private places. In expanded PVC , in 2 wood finishes 4 in matching colors to combine with various wood finishes. Easy to lay with fixing silicone.

transition profiles

PGAW... 15  
scale 1:1

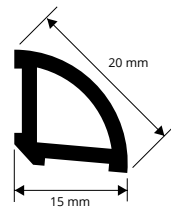

EXAMPLES AND INSTRUCTIONS FOR LAYING METHODS

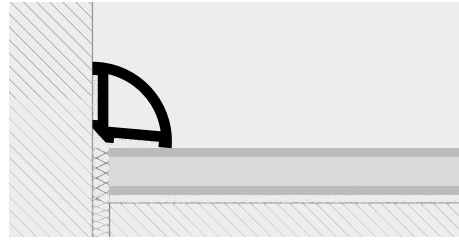

1. Choose "PROANGLE WOOD" color and/or wood finish required.
2. The laying must be carried out using fast fixing acrylic silicone, mastic, bostik, suitable for glueing PVC with mortar-plaster-wall units etc., or fix using screws/nails.



**EXPANDED PVC - 2 WOOD FINISHING**  
bar length 2,5 lm - pack. 40 Pcs - 100 lm

| Article    | L x H mm | €/lm | €/Pc |
|------------|----------|------|------|
| PGAW... 15 | 15 x 15  | 0,58 | 1,45 |



**EXPANDED PVC - 4 COLOURS**  
bar length 2,5 lm - pack. 40 Pcs - 100 lm

| Article    | L x H mm | €/lm | €/Pc |
|------------|----------|------|------|
| PGAW... 15 | 15 x 15  | 0,53 | 1,33 |

Available in the wood finishes: 05W - 10W, and colours: - GC - GS - N.  
The code of the selected colour must be added to the article code. E.g.: PGAW...15 (chosen finish black) PGAWN 15.

The shade of the wooden finish in rigid expanded vinyl resin/PVC results slightly different from the film usually applied on the profiles in aluminium.

COLOURS

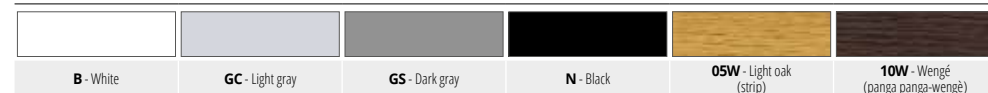

© 2010 All rights reserved by Progress Profiles, Printed in Italy

© 2010 All rights reserved by Progress Profiles, Printed in Italy



SKIRTING BOARDS